

# Klemmhalter, Innenbearbeitung, Quadratschaft

90 Grad gekröpfte Ausführung.

# Toolholder, Internal Applications, Square Shank

90 degree cranked style.

Anzugsmoment (Schraube) // Tightening torque (screw)  
**7,0 Nm**

Bitte Hinweise im Anhang beachten // Please read add. notes  
**MASTER (Seite/Page 153)**

TW

ST

R

Scan QR-Code

Legende  
Legend **155**

Oder besuchen Sie // Or Visit  
[www.simtek.info/cp/1026](http://www.simtek.info/cp/1026)



Abbildung zeigt / Drawing shows: A04.1616.G.100 R



- Hauptsächlich geeignet für diese Flächen  
Mainly designed for these surfaces
- Je nach Schneidplatte ebenfalls möglich  
Also possible depending on insert type

ØD	h	b	L1	Artikelnummer Part number	Webcode www.simtek.com/webcode	b1	f	hk	h1	LK	Schraube Screw	Schraubenschlüssel Screw driver	Connectcode www.simtek.com/code
mm	mm	mm	mm			mm	mm	mm	mm	mm			
<b>▼ h = 12,0 mm</b>													
4,0	12,0	12,0	80,0	<b>A04.1212.G.080 R/L</b>	R AW2V L AW2U	20,0	9,0	18,0	12,0	20,0	ATKW	T15F	R A04.R   A04C.R L A04.L   A04C.L
5,0	12,0	12,0	80,0	<b>A05.1212.G.080 R/L</b>	R AW2Y L AW2X	25,0	9,0	18,0	12,0	20,0	ATKW	T15F	R A05.R L A05.L
6,0	12,0	12,0	80,0	<b>A06.1212.G.080 R/L</b>	R AW22 L AW21	25,0	9,0	18,0	12,0	20,0	ATKW	T15F	R A06.R L A06.L
7,0	12,0	12,0	80,0	<b>A07.1212.G.080 R/L</b>	R AW26 L AW25	25,0	9,0	18,0	12,0	20,0	ATKW	T15F	R A07.R L A07.L
<b>▼ h = 12,7 mm</b>													
5,0	12,7	12,7	80,0	<b>A05.0.500.G.080 R</b>	A5AV	25,0	9,0	18,0	12,7	20,0	ATKW	T15F	A05.R <span style="float: right; font-size: 8px;">Inch</span>
<b>▼ h = 15,875 mm</b>													
5,0	15,875	15,875	100,0	<b>A05.0.625.G.100 R</b>	A5AX	25,0	9,0	22,0	15,9	20,0	ATKW	T15F	A05.R <span style="float: right; font-size: 8px;">Inch</span>
<b>▼ h = 16,0 mm</b>													
4,0	16,0	16,0	100,0	<b>A04.1616.G.100 R/L</b>	R AW4E L AW2W	20,0	9,0	22,0	16,0	20,0	ATKW	T15F	R A04.R   A04C.R L A04.L   A04C.L
5,0	16,0	16,0	100,0	<b>A05.1616.G.100 R/L</b>	R AW20 L AW2Z	25,0	9,0	22,0	16,0	20,0	ATKW	T15F	R A05.R L A05.L
6,0	16,0	16,0	100,0	<b>A06.1616.G.100 R/L</b>	R AW24 L AW23	25,0	9,0	22,0	16,0	20,0	ATKW	T15F	R A06.R L A06.L
7,0	16,0	16,0	100,0	<b>A07.1616.G.100 R/L</b>	R AW28 L AW27	25,0	9,0	22,0	16,0	20,0	ATKW	T15F	R A07.R L A07.L

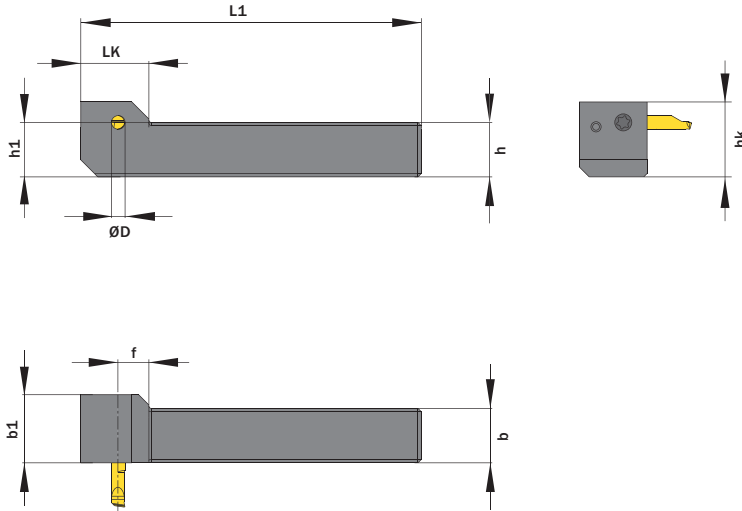
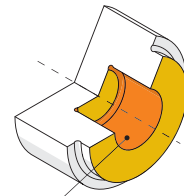
Bestellbeispiel // Order example: **A06.1616.G.100 R** (R = Rechte Ausführung // Right hand version)

Eine Umschlüsselungsliste von **Webcode zu Schrauben bzw. Spannmuttern** finden Sie auf Seite **766**.  
A conversion list from **webcode to screws as well as standard screw nuts** can be found on page **766**.