

Doppelklemmhalter, Innenbearbeitung

Doppelklemmhalter für passende Langdrehautomaten.

Toolholder, Internal Applications

Double toolholder for swiss type machines.

Anzugsmoment (Schraube) // Tightening torque (screw)
7,0 Nm

Bitte Hinweise im Anhang beachten // Please read add. notes
MASTER (Seite/Page 153)

TW Legende
ST Legend **155**

Scan QR-Code Oder besuchen Sie // Or Visit www.simtek.info/cp/742

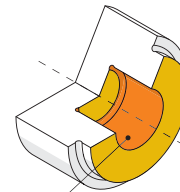
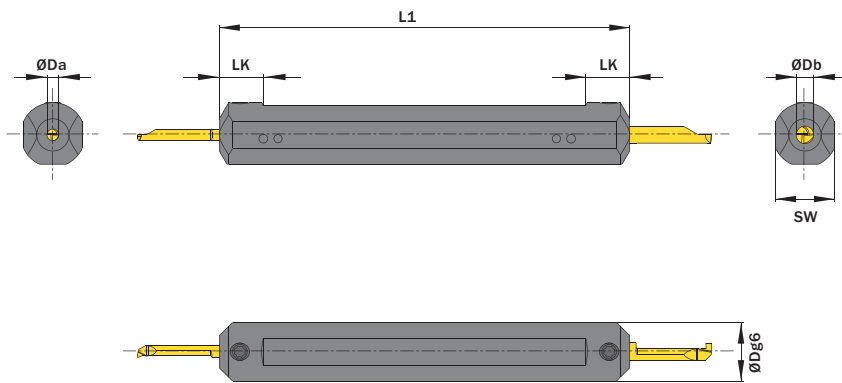

- Hauptsächlich geeignet für diese Flächen
Mainly designed for these surfaces
- Je nach Schneidplatte ebenfalls möglich
Also possible depending on insert type

Abbildung zeigt / Drawing shows: A04.0.750.0140.A06

ØDa	ØDg6	L1	ØDb	Artikelnummer Part number	Webcode www.simtek.com/webcode	LK	SW	Schraube Screw	Schraubenschlüssel Screw driver	Connectcode www.simtek.com/ccode
mm	mm	mm	mm			mm	mm			
▼ ØDa = 4,0 mm										
4,0	19,05	140,0	6,0	A04.0.750.0140.A06	AHWS	15,0	17,0	ATKW	T15F	A04.L A04.R A04CL A04C.R A06.L A06.R
4,0	20,0	140,0	4,0	A04.0020.0140.A04	APJQ	15,0	17,0	ATKW	T15F	A04.L A04.R A04CL A04C.R
4,0	20,0	140,0	5,0	A04.0020.0140.A05	AMFØ	15,0	17,0	ATKW	T15F	A04.L A04.R A04CL A04C.R A05.L A05.R
4,0	20,0	140,0	6,0	A04.0020.0140.A06	AAWT	15,0	18,0	ATKW	T15F	A04.L A04.R A04CL A04C.R A06.L A06.R
4,0	22,0	140,0	4,0	A04.0022.0140.A04	AGV1	15,0	20,0	ATKW	T15F	A04.L A04.R A04CL A04C.R
4,0	22,0	140,0	6,0	A04.0022.0140.A06	AA6P	15,0	20,0	ATKW	T15F	A04.L A04.R A04CL A04C.R A06.L A06.R
4,0	25,0	140,0	6,0	A04.0025.0140.A06	AEZP	15,0	23,0	ATKW	T15F	A04.L A04.R A04CL A04C.R A06.L A06.R
4,0	28,0	140,0	6,0	A04.0028.0140.A06	AB7A	15,0	26,0	ATKW	T15F	A04.L A04.R A04CL A04C.R A06.L A06.R
▼ ØDa = 5,0 mm										
5,0	20,0	140,0	5,0	A05.0020.0140.A05	AK9Y	15,0	17,0	ATKW	T15F	A05.L A05.R
5,0	20,0	140,0	6,0	A05.0020.0140.A06	APND	15,0	17,0	ATKW	T15F	A05.L A05.R A06.L A06.R
▼ ØDa = 6,0 mm										
6,0	20,0	140,0	6,0	A06.0020.0140.A06	AGXT	15,0	17,0	ATKW	T15F	A06.L A06.R
6,0	22,0	140,0	6,0	A06.0022.0140.A06	AJC6	15,0	19,0	ATKW	T15F	A06.L A06.R

Bestellbeispiel // Order example: **A04.0020.0140.A04**

Eine Umschlüsselungsliste von **Webcode zu Schrauben bzw. Spannmuttern** finden Sie auf Seite **766**.
A conversion list from **webcode to screws as well as standard screw nuts** can be found on page **766**.

simturn AX
simturn DX
simturn PX
simturn H2
simturn K2
simturn GX
simturn E3
simturn E12
simturn FX
simturn Decolletage
simturn OA
Index