

Klemmhalter, Innenbearbeitung, Gekröpft

Gekröpfte Ausführung für passende Langdrehautomaten und Mehrspindler.

Toolholder, Internal Applications, Cranked

Cranked toolholder for swiss type machines.

Anzugsmoment (Schraube) // Tightening torque (screw)

7,0 Nm

Bitte Hinweise im Anhang beachten // Please read add. notes

MASTER (Seite/Page 153)



Legende
Legend **155**

Scan QR-Code Oder besuchen Sie // Or Visit www.simtek.info/cp/744

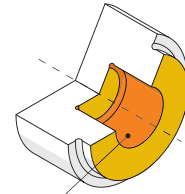
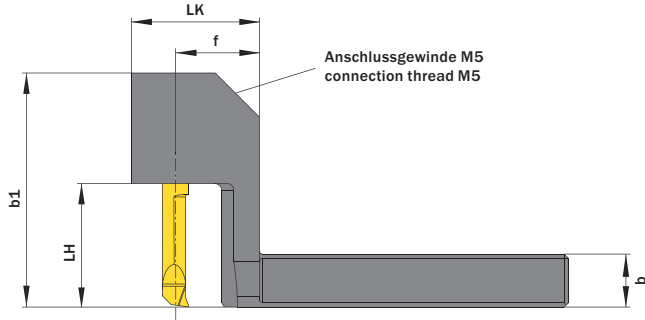
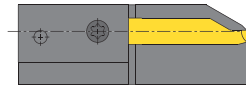
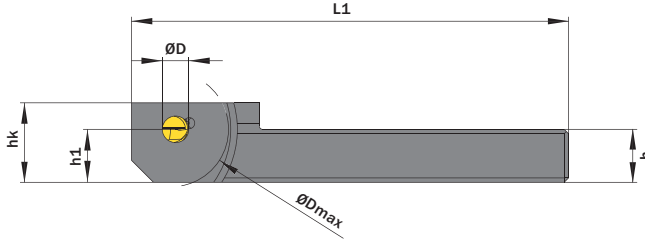

- Hauptsächlich geeignet für diese Flächen
Mainly designed for these surfaces
- Je nach Schneidplatte ebenfalls möglich
Also possible depending on insert type

| ØD | h | b | Artikelnummer Part number | Webcode www.simtek.com/webcode | b1 | ØDmax | f | hk | h1 | L1 | LK | LH | Schraube Screw | Schraubenschlüssel Screw driver | Connectcode www.simtek.com/code |
|-----|-------|-------|------------------------------|-----------------------------------|------|-------|------|------|------|-------|------|------|-------------------|------------------------------------|------------------------------------|
| mm | mm | mm | | | mm | mm | mm | mm | mm | mm | mm | mm | | | |
| 4,0 | 9,525 | 9,525 | A04.0.375.10 R/L | R A5U3 L A5U5 | 31,5 | 26,0 | 19,0 | 16,0 | 9,52 | 99,0 | 29,0 | 13,0 | ATKW | T15F R | A04.R A04C.R L A04.L A04C.L |
| 4,0 | 9,525 | 9,525 | A04.0.375.15 R/L | R AC1Z L AMDE | 36,5 | 26,0 | 19,0 | 16,0 | 9,52 | 99,0 | 29,0 | 18,0 | ATKW | T15F R | A04.R A04C.R L A04.L A04C.L |
| 4,0 | 12,7 | 12,7 | A04.0.500.10 R | A235 | 31,5 | 26,0 | 19,0 | 19,0 | 12,7 | 99,0 | 29,0 | 13,0 | ATKW | T15F | A04.R A04C.R |
| 4,0 | 12,7 | 12,7 | A04.0.500.15 R/L | R AB49 L AD3A | 36,5 | 26,0 | 19,0 | 19,0 | 12,7 | 99,0 | 29,0 | 18,0 | ATKW | T15F R | A04.R A04C.R L A04.L A04C.L |
| 4,0 | 8,0 | 8,0 | A04.0808.10 R/L | R APYN L AA2M | 31,5 | 26,0 | 19,0 | 14,0 | 8,0 | 99,0 | 29,0 | 13,0 | ATKW | T15F R | A04.R A04C.R L A04.L A04C.L |
| 4,0 | 8,0 | 8,0 | A04.0808.15 R/L | R AF3M L AKCJ | 36,5 | 26,0 | 19,0 | 14,0 | 8,0 | 99,0 | 29,0 | 18,0 | ATKW | T15F R | A04.R A04C.R L A04.L A04C.L |
| 4,0 | 10,0 | 10,0 | A04.1010.10 R/L | R ANAT L AEØP | 31,5 | 26,0 | 19,0 | 16,0 | 10,0 | 99,0 | 29,0 | 13,0 | ATKW | T15F R | A04.R A04C.R L A04.L A04C.L |
| 4,0 | 10,0 | 10,0 | A04.1010.15 R/L | R AF2T L AAX5 | 36,5 | 26,0 | 19,0 | 16,0 | 10,0 | 99,0 | 29,0 | 18,0 | ATKW | T15F R | A04.R A04C.R L A04.L A04C.L |
| 4,0 | 12,0 | 12,0 | A04.1212.10 R/L | R AHFU L ANE7 | 31,5 | 26,0 | 19,0 | 18,0 | 12,0 | 99,0 | 29,0 | 13,0 | ATKW | T15F R | A04.R A04C.R L A04.L A04C.L |
| 4,0 | 12,0 | 12,0 | A04.1212.15 R/L | R AFNB L AEØP | 36,5 | 26,0 | 19,0 | 18,0 | 12,0 | 99,0 | 29,0 | 18,0 | ATKW | T15F R | A04.R A04C.R L A04.L A04C.L |
| 4,0 | 16,0 | 16,0 | A04.1616.15 R/L | R ABWP L AHM3 | 36,5 | 36,0 | 24,0 | 22,0 | 16,0 | 104,0 | 34,0 | 18,0 | ATKW | T15F R | A04.R A04C.R L A04.L A04C.L |

Verwandte Werkzeuge finden Sie auch auf der folgenden Seite!
Related Items can be found on the following page as well!

Fortgesetzte Tabelle
Continued Table

Bestellbeispiel // Order example: **A04.1212.15 R** (R = Rechte Ausführung // Right hand version)

Eine Umschlüsselungliste von Webcode zu Schrauben bzw. Spannmuttern finden Sie auf Seite 766.
A conversion list from webcode to screws as well as standard screw nuts can be found on page 766.