

**SİMTEK**

En Yüksek  
Talepler için  
Makine Takımları

Geniş çaplı  
**kanal açma takımları.**

Wide-spread  
**grooving system.**

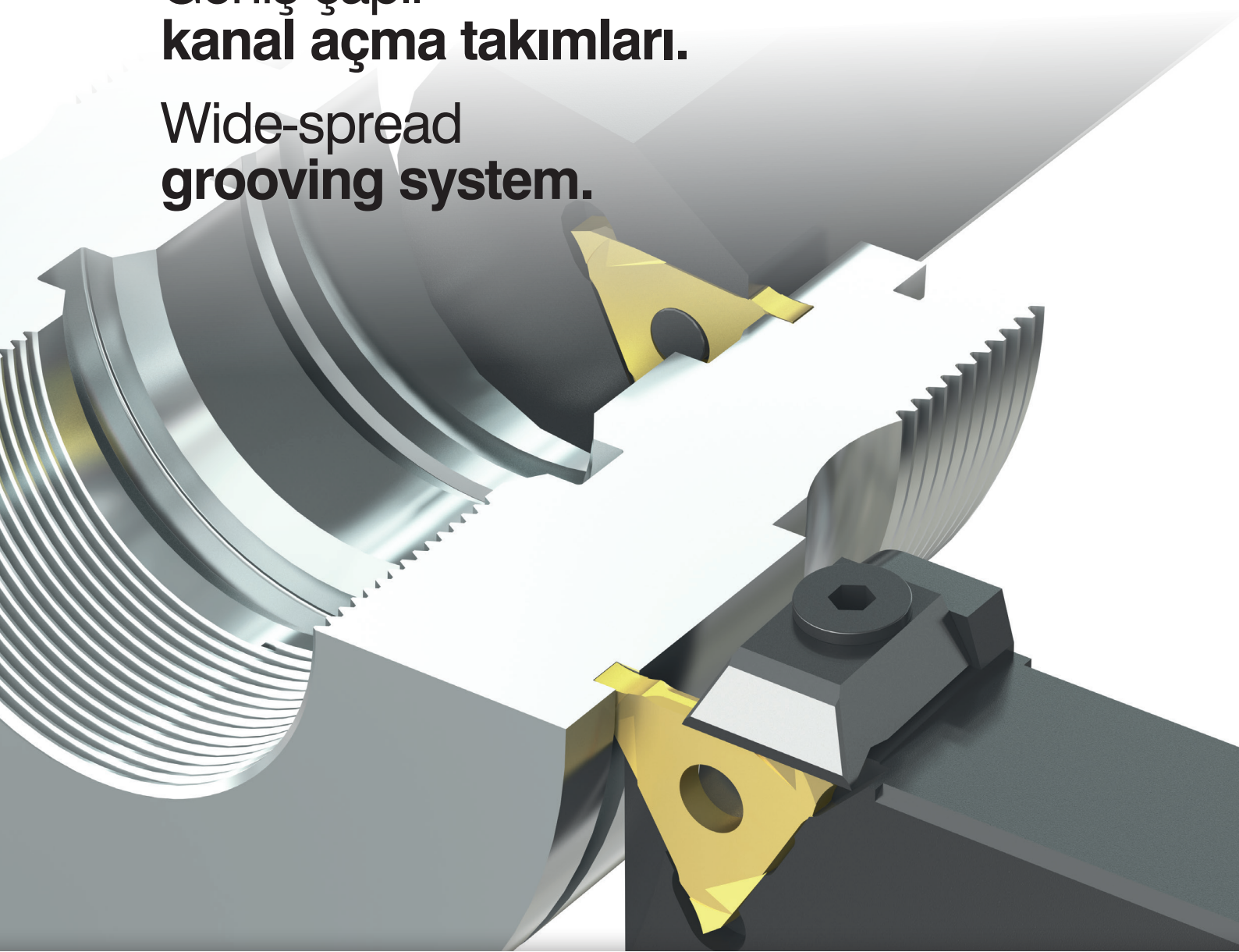

**simturnE12**  
SIMTEK small part machining type E12

**R20 TR-Edition**



En Yüksek  
Talepler için  
Makine Takımları

## İletişim // Contact

Simtek İth. İhr. San. ve Tic. Ltd. Şti.  
Yolören Mh 879. Sk No: 3  
TR- 10300 Edremit / Balıkesir

**Telefon** +90 266 376 11 61  
**Fax** +90 266 376 12 34  
**E-posta** sales.tr@simtek.com  
**Web** www.simtek.com/turkiye

## Takım sistemine genel bakış The Tool System Overview

Geniş çaplı kanal açma sistemi.  
Wide-spread grooving system.

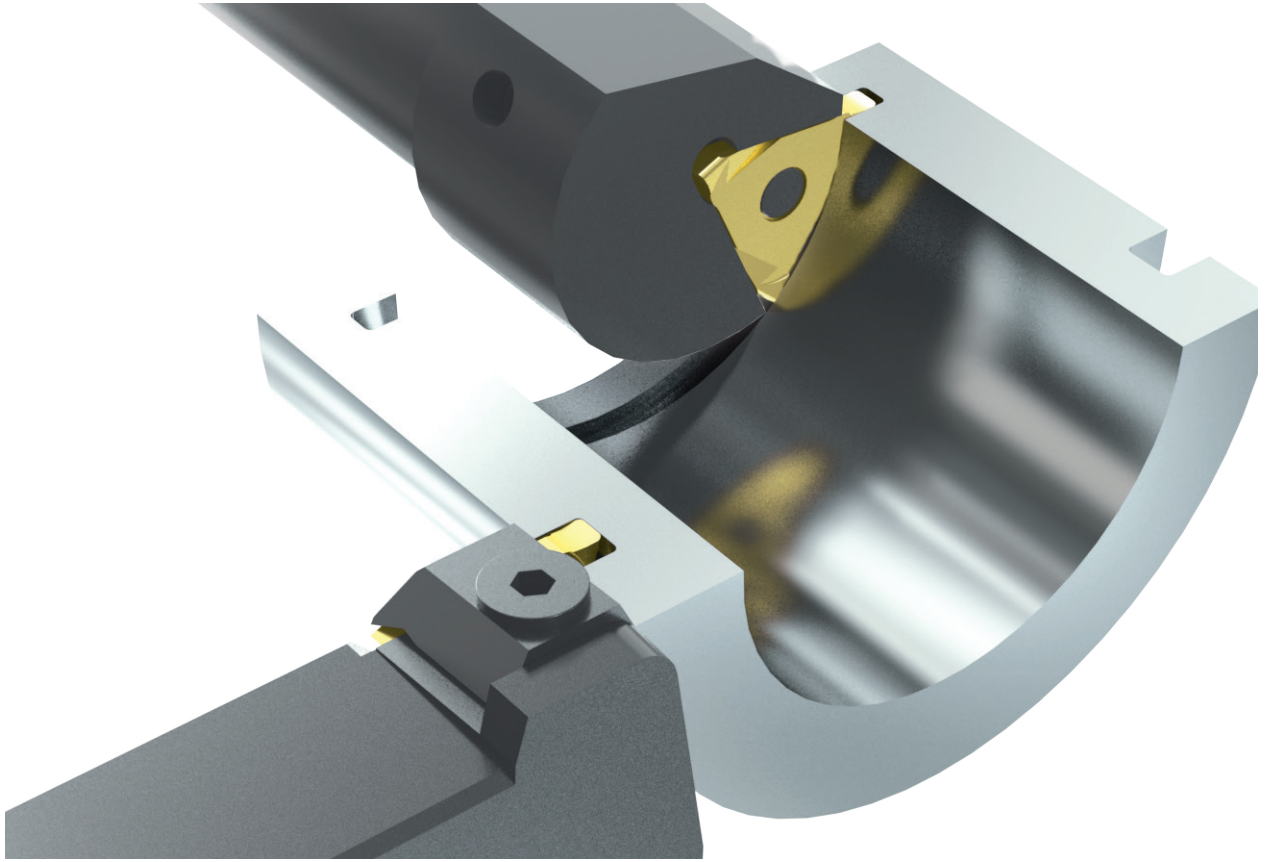

Üç kesicili değiştirilebilir karbür kesici uç ve çelik tutucudan oluşan takım sistemi.

Dış çap uygulamalar için 8,0 mm'ye kadar olası kesme derinliği. Hassas taşlanmış kesme kenarı geometrileri mevcuttur.

Tool system of triple-edged indexable carbide cutting insert and steel toolholders.

Possible depth of cut up to 8,0 mm for external applications. Range of ground cutting edge geometries available.

## Sistem detayları The System Details

Lütfen sayfadaki genel kullanım talimatlarını okuyun  
Please read the general instructions for use on page

44

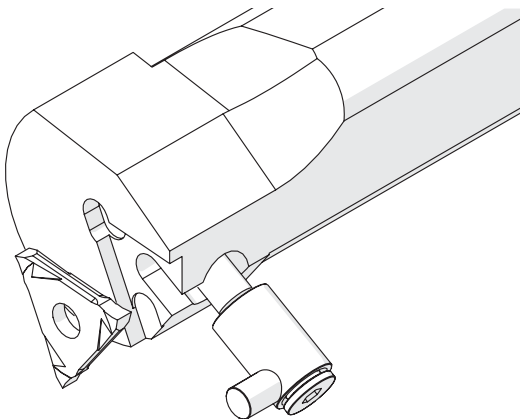
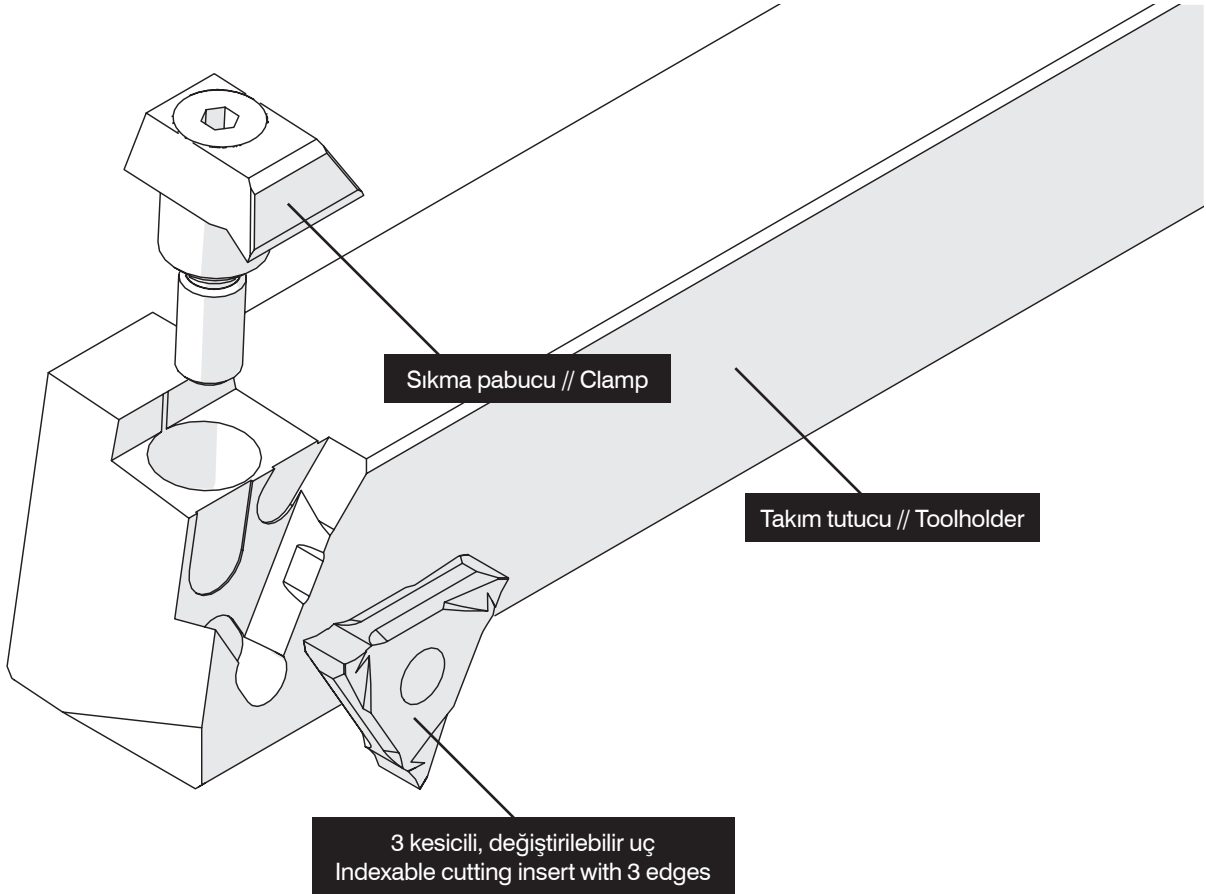

**İç ve Dış çap uygulamalar için mevcuttur**  
Available for internal and external applications

**Dış çap // External**

Maksimum kesme derinliği // Maximum cutting depth: 8,0 mm

**İç çap // Internal**

Delik çapı itibarıyla // As of bore diameter: 46,0 mm

## Standart Uygulamalar Standard Applications

Sayfa itibarı ile  
As of page

16

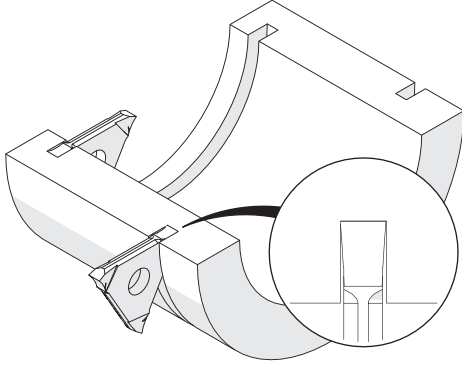

Kanal açma, Segman kanalları  
Grooving, Circlip Ring Grooves

Sayfa itibarı ile  
As of page

23

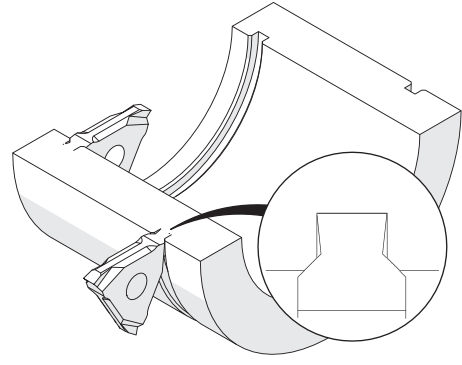

Kanal açma, Segman kanalları, Pahlı  
Grooving, Circlip Ring Grooves with Chamfer

Sayfa itibarı ile  
As of page

25

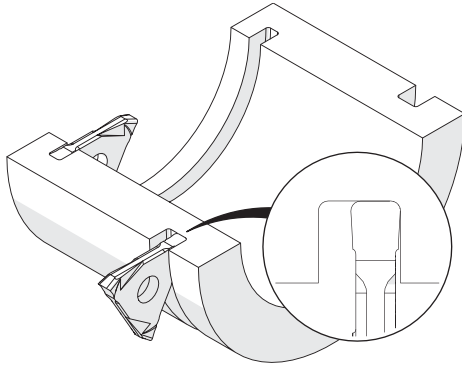

Kanal açma ve Profil tornalama  
Grooving and Profiling

Sayfa  
Page

27

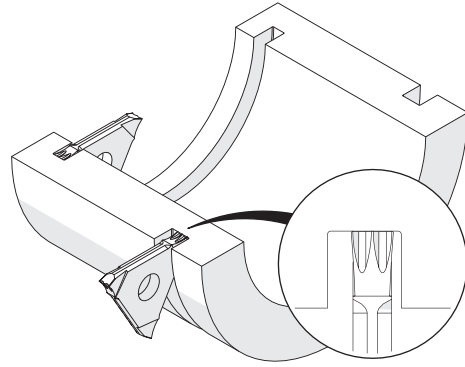

Kanal açma ve Tornalama  
Grooving and Turning

Sayfa  
Page

28

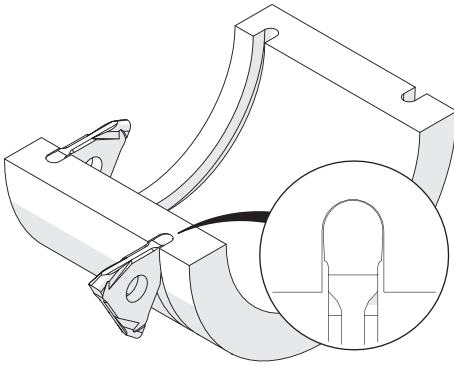

Kanal açma ve Profil tornalama, Full radius  
Grooving and Profiling, Full Radius

Sayfa  
Page

29

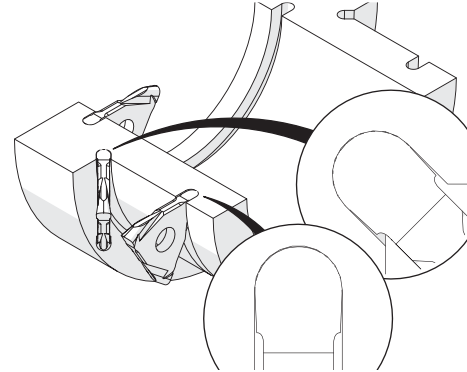

Köşe boşaltma, Kanal açma ve Profil tornalama,  
Full radius  
Corner Reliefs, Grooving and Profiling, Full Radius

## Standart Uygulamalar Standard Applications

Sayfa itibarı ile  
As of page

**30**

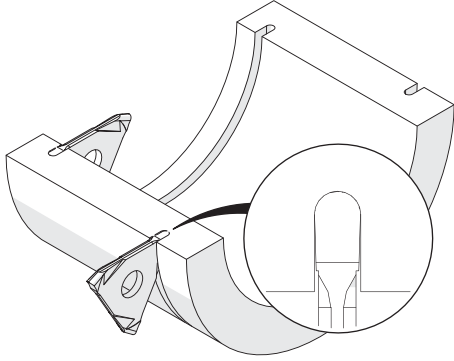

Kanal açma, Yuvarlak telli segman  
Grooving, Round-Wire Snap-Ring

Sayfa itibarı ile  
As of page

**32**

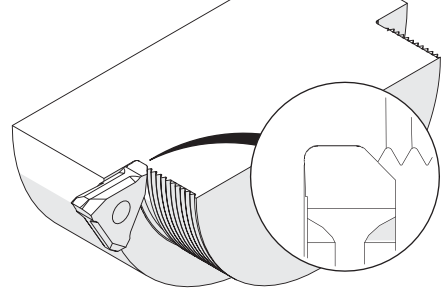

Dış sonu boşaltma  
Thread Reliefs

Sayfa  
Page

**34**

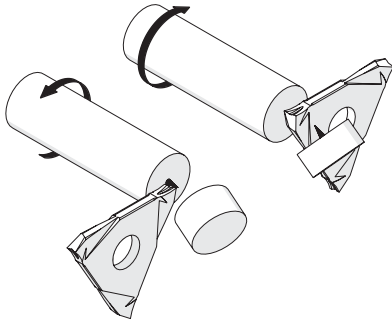

Kesme  
Parting off

Sayfa  
Page

**35**

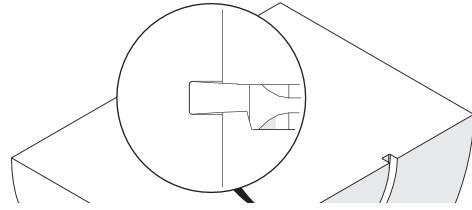

Alın kanal açma  
Face Grooving

Sayfa  
Page

**36**

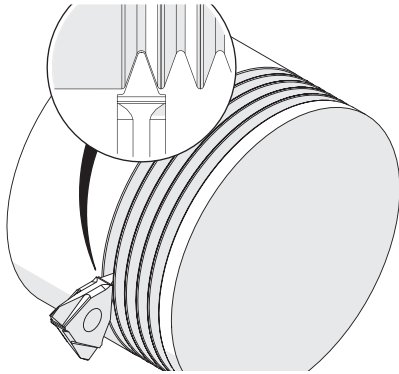

Poli-V Kasnak kanalları  
Poly-V Belt-Grooves

## Dış çap uygulamalar için takım tutucu

Dış çap uygulamalar için takım tutucu.

## Toolholder, External Applications

Toolholder for external applications.

Sıkma torku (Vida) // Tightening torque (Screw)

6,0 Nm



Referans  
Legend 37

QR-Code [www.simtek.info/cp/487](http://www.simtek.info/cp/487)  
Tara // Scan veya ziyaret edin // or visit

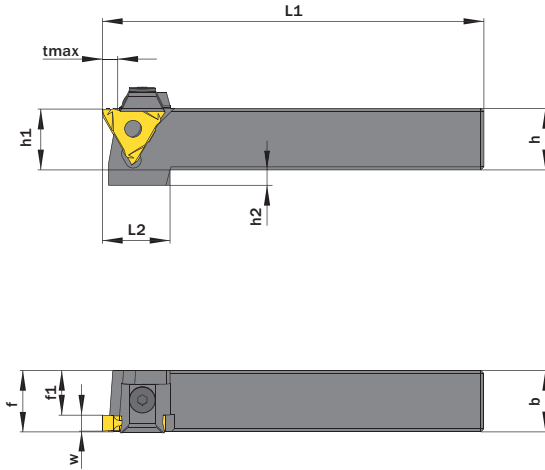

f ve w ölçüleri kesici uca göre değişiklik gösterebilir  
Measures f and w depend on cutting insert

Görseledeki çizim/Drawing shows: E60.2020.04 R

Ød'ye bağlı olarak tmax ölçüleri  
tmax depends on workpiece diameter Ød

Ød	tmax
≤ Ø40,0 mm / ≤ Ø1.574"	6,0 mm / 0.236"
> Ø40,0 mm / > Ø1.574"	4,0 mm / 0.157"

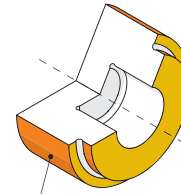

- Öncelikli kullanım alanı  
Mainly designed for these surfaces
- Kullanılan uca göre ekstra kullanım alanı  
Also possible depending on insert/fixation type

h	b	Ürün kodu Part number	Webcode <a href="http://www.simtek.com/webcode">www.simtek.com/webcode</a>	f1	h1 <sup>js14</sup>	h2	L1	L2	tmax	w ≥	w ≤	Sıkma Pabucu Clamp	Connectcode <a href="http://www.simtek.com/cocode">www.simtek.com/cocode</a>
mm	mm			mm	mm	mm	mm	mm	mm	mm	mm		
▼ h = 12,0 mm													
12,0	12,0	<b>E60.1212.01 R/L</b>	R AFXZ L AG4T	10,5	12,0	13,0	100,0	24,0	4,0	0,5	2,0	E12.1.3	<b>E12.A1</b>
12,0	12,0	<b>E60.1212.23 R/L</b>	R ACFC L ADF8	10,0	12,0	13,0	100,0	24,0	6,0	1,0	2,5	E12.1.3	<b>E12.A2</b>
12,0	12,0	<b>E60.1212.02 R/L</b>	R AD5Ø L AAPU	9,5	12,0	13,0	100,0	24,0	6,0	2,0	3,0	E12.1.3	<b>E12.B2</b>
12,0	12,0	<b>E60.1212.03 R/L</b>	R ABS4 L AG3U	8,5	12,0	13,0	100,0	24,0	6,0	3,0	4,0	E12.1.3	<b>E12.C3</b>
▼ h = 16,0 mm													
16,0	16,0	<b>E60.1616.01 R/L</b>	R ABB3 L AAY4	14,5	16,0	9,0	125,0	22,0	4,0	0,5	2,0	E16.1.4	<b>E12.A1</b>
16,0	16,0	<b>E60.1616.23 R/L</b>	R AE9Q L AM6Z	14,0	16,0	9,0	125,0	22,0	6,0	1,0	2,5	E16.1.4	<b>E12.A2</b>
16,0	16,0	<b>E60.1616.02 R/L</b>	R AEHG L AAE1	13,5	16,0	9,0	125,0	22,0	6,0	2,0	3,0	E16.1.4	<b>E12.B2</b>
16,0	16,0	<b>E60.1616.03 R/L</b>	R AE36 L AGDN	12,5	16,0	9,0	125,0	22,0	6,0	3,0	4,0	E16.1.4	<b>E12.C3</b>
16,0	16,0	<b>E60.1616.04 R/L</b>	R AFØS L AHTØ	11,5	16,0	9,0	125,0	22,0	6,0	4,0	6,3	E16.1.4	<b>E12.D4</b>
▼ h = 20,0 mm													
20,0	20,0	<b>E60.2020.01 R/L</b>	R ADXD L AG3J	18,5	20,0	5,0	125,0	21,0	4,0	0,5	2,0	E20.1.4	<b>E12.A1</b>
20,0	20,0	<b>E60.2020.23 R/L</b>	R AMQ8 L AM2P	18,0	20,0	5,0	125,0	21,0	6,0	1,0	2,5	E20.1.4	<b>E12.A2</b>
20,0	20,0	<b>E60.2020.02 R/L</b>	R APY1 L APX5	17,5	20,0	5,0	125,0	21,0	6,0	2,0	3,0	E20.1.4	<b>E12.B2</b>
20,0	20,0	<b>E60.2020.03 R/L</b>	R APWN L ANGC	16,5	20,0	5,0	125,0	21,0	6,0	3,0	4,0	E20.1.4	<b>E12.C3</b>
20,0	20,0	<b>E60.2020.04 R/L</b>	R AH26 L AAWF	14,8	20,0	5,0	125,0	21,0	6,0	4,0	6,3	E20.1.4	<b>E12.D4</b>

Benzer takımları bir sonraki sayfada bulabilirsiniz!  
Related Items can be found on the following page as well!

Tablonun Devamı  
Continued Table

|| Sipariş örneği // Order example: **E60.2020.01 R** (R = Sağ model // Right hand version)

|| Yedek vida // Spare screw: E M6x25 SW3

# Dış çap uygulamalar için takım tutucu

Dış çap uygulamalar için takım tutucu.

## Toolholder, External Applications

Toolholder for external applications.

Sıkma torku (Vida) // Tightening torque (Screw)

6,0 Nm



Referans  
Legend 37

QR-Code [www.simtek.info/cp/863](http://www.simtek.info/cp/863)  
Tara // Scan veya ziyaret edin // or visit

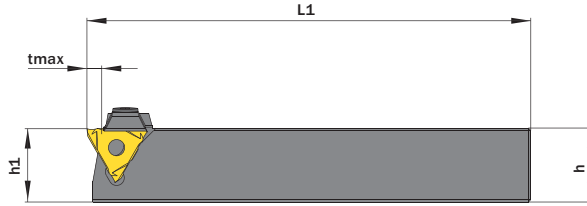

f ve w ölçüleri kesici uca göre değişiklik gösterebilir  
Measures f and w depend on cutting insert

Ø'd'ye bağlı olarak tmax ölçüleri  
tmax depends on workpiece diameter  
(Ød) tmax

≤ Ø40,0 mm / ≤ Ø1.574" 6,0 mm / 0.236"

> Ø40,0 mm / > Ø1.574" 4,0 mm / 0.157"

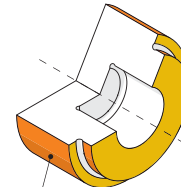

- Öncelikli kullanım alanı  
Mainly designed for these surfaces
- Kullanılan uca göre ekstra kullanım alanı  
Also possible depending on insert/fixation type

Görseldeki çizim/Drawing shows: E60.2525.04 R

h	b	Ürün kodu Part number	Webcode <a href="http://www.simtek.com/webcode">www.simtek.com/webcode</a>	f1	h1 <sup>is14</sup>	L1	tmax	w ≥	w ≤	Sıkma Pabuçu Clamp	Connectcode <a href="http://www.simtek.com/code">www.simtek.com/code</a>
mm	mm			mm	mm	mm	mm	mm	mm		

Tablonun Devamı  
Continued Table

Benzer takımları bir önceki sayfada bulabilirsiniz!  
Related items can be found on the following page as well!

▼ h = 25,0 mm

25,0	25,0	<b>E60.2525.01 R/L</b>	R AA2H L ADW8	23,5	25,0	150,0	4,0	0,5	2,0	E20.1.4	<b>E12.A1</b>
25,0	25,0	<b>E60.2525.23 R/L</b>	R AGZ9 L AMA6	23,1	25,0	150,0	6,0	1,0	2,5	E20.1.4	<b>E12.A2</b>
25,0	25,0	<b>E60.2525.02 R/L</b>	R AG39 L AEVØ	22,5	25,0	150,0	6,0	2,0	3,0	E20.1.4	<b>E12.B2</b>
25,0	25,0	<b>E60.2525.03 R/L</b>	R AD97 L APFP	21,5	25,0	150,0	6,0	3,0	4,0	E20.1.4	<b>E12.C3</b>
25,0	25,0	<b>E60.2525.04 R/L</b>	R APYG L ABNF	19,8	25,0	150,0	6,0	4,0	6,3	E20.1.4	<b>E12.D4</b>

▼ h = 32,0 mm

32,0	32,0	<b>E60.3232.01 R/L</b>	R ADØM L APHØ	30,5	32,0	170,0	4,0	0,5	2,0	E20.1.4	<b>E12.A1</b>
32,0	32,0	<b>E60.3232.02 R/L</b>	R AMKM L AD7B	29,5	32,0	170,0	6,0	2,0	3,0	E20.1.4	<b>E12.B2</b>
32,0	32,0	<b>E60.3232.03 R/L</b>	R AHJQ L AAXU	28,5	32,0	170,0	6,0	3,0	4,0	E20.1.4	<b>E12.C3</b>
32,0	32,0	<b>E60.3232.04 R/L</b>	R AA5F L AN3K	26,8	32,0	170,0	6,0	4,0	6,3	E20.1.4	<b>E12.D4</b>

■ Sipariş örneği // Order example: **E60.2525.01 R** (R = Sağ model // Right hand version)

■ Yedek vida // Spare screw: E M6x25 SW3



## Dış çap uygulamalar için takım tutucu

Dış çap uygulamalarda 8,0 mm'ye kadar kesme derinliği olan takım tutucu.

## Toolholder, External Applications

Toolholder for external applications and cutting depths up 8,0 mm.



Referans  
Legend 37



QR-Code [www.simtek.info/cp/489](http://www.simtek.info/cp/489)  
Tara // Scan veya ziyaret edin // or visit

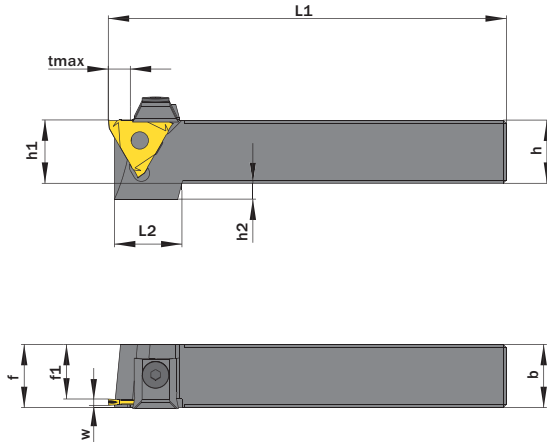

f ve w ölçüleri kesici uca göre değişiklik gösterebilir  
Measures f and w depend on cutting insert

Görseldeki çizim/Drawing shows: E90.2020.02 R

Ø'd'ye bağlı olarak tmax ölçüleri tmax depends on workpiece diameter Ød		
up to 0,787" ≤ Ø4,921"	tmax for E90.***.01 0,315"	tmax for E90.***.02, 03, 04 0,315"

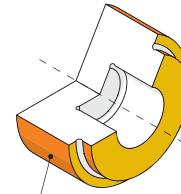

- Öncelikli kullanım alanı  
Mainly designed for these surfaces
- Kullanılan uca göre ekstra kullanım alanı  
Also possible depending on insert/fixation type

h	b	Ürün kodu Part number	Webcode <a href="http://www.simtek.com/webcode">www.simtek.com/webcode</a>	f1	h1 <sup>js14</sup>	h2	L1	L2	tmax	w ≥	w ≤	Sıkma Pabuçu Clamp	Connectcode <a href="http://www.simtek.com/code">www.simtek.com/code</a>
mm	mm			mm	mm	mm	mm	mm	mm	mm	mm		
▼ h = 12,0 mm													
12,0	12,0	<b>E90.1212.01 R/L</b>	R AJSB L AF2Z	10,5	12,0	13,0	100,0	24,0	8,0	0,5	2,0	E12.1.3	<b>E12.A1</b>
▼ h = 16,0 mm													
16,0	16,0	<b>E90.1616.01 R/L</b>	R AH24 L AK3A	14,5	16,0	9,0	125,0	24,0	8,0	0,5	2,0	E16.1.4	<b>E12.A1</b>
16,0	16,0	<b>E90.1616.02 R/L</b>	R AGNB L AE8N	13,5	16,0	9,0	125,0	22,0	8,0	1,9	3,0	E16.1.4	<b>E12.B2</b>
▼ h = 20,0 mm													
20,0	20,0	<b>E90.2020.01 R/L</b>	R AGHV L AGGM	18,5	20,0	5,0	125,0	22,0	8,0	0,5	2,0	E20.1.4	<b>E12.A1</b>
20,0	20,0	<b>E90.2020.02 R/L</b>	R AG14 L AK5V	17,5	20,0	5,0	125,0	22,0	8,0	1,9	3,0	E20.1.4	<b>E12.B2</b>
20,0	20,0	<b>E90.2020.03 R/L</b>	R AFJM L ACET	16,5	20,0	5,0	125,0	22,0	8,0	3,0	4,0	E20.1.4	<b>E12.C3</b>
20,0	20,0	<b>E90.2020.04 R/L</b>	R AJ82 L AFDT	14,8	20,0	5,0	125,0	22,0	8,0	4,0	5,3	E20.1.4	<b>E12.D4</b>
▼ h = 25,0 mm													
25,0	25,0	<b>E90.2525.01 R/L</b>	R AAX9 L AHAH	23,5	25,0	-	150,0	-	8,0	0,5	2,0	E20.1.4	<b>E12.A1</b>
25,0	25,0	<b>E90.2525.02 R/L</b>	R AAYW L AHA6	22,5	25,0	-	150,0	-	8,0	1,9	3,0	E20.1.4	<b>E12.B2</b>
25,0	25,0	<b>E90.2525.03 R/L</b>	R AK6S L AP3W	21,5	25,0	-	150,0	-	8,0	3,0	4,0	E20.1.4	<b>E12.C3</b>
25,0	25,0	<b>E90.2525.04 R/L</b>	R ACQG L AMCD	19,8	25,0	-	150,0	-	8,0	4,0	5,3	E20.1.4	<b>E12.D4</b>
▼ h = 32,0 mm													
32,0	32,0	<b>E90.3232.01 R/L</b>	R AM6M L AEA0	30,5	32,0	-	170,0	-	8,0	0,5	2,0	E20.1.4	<b>E12.A1</b>
32,0	32,0	<b>E90.3232.02 R/L</b>	R ADM4 L AJ7Y	29,5	32,0	-	170,0	-	8,0	1,9	3,0	E20.1.4	<b>E12.B2</b>
32,0	32,0	<b>E90.3232.03 R/L</b>	R AMZ5 L AN4K	28,5	32,0	-	170,0	-	8,0	3,0	4,0	E20.1.4	<b>E12.C3</b>
32,0	32,0	<b>E90.3232.04 R/L</b>	R AA25 L AJB9	26,8	32,0	-	170,0	-	8,0	4,0	5,3	E20.1.4	<b>E12.D4</b>

■ Sipariş örneği // Order example: **E90.2020.02 R** (R = Sağ model // Right hand version)

■ Yedek vida // Spare screw: E M6x25 SW3

## Dış çap uygulamalar için takım tutucu

Dış çap uygulamalar için takım tutucu.

## Toolholder, External Applications

Toolholder for external applications.

Sıkma torku (Vida) // Tightening torque (Screw)

6,0 Nm



Referans  
Legend 37

QR-Code [www.simtek.info/cp/492](http://www.simtek.info/cp/492)  
Tara // Scan veya ziyaret edin // or visit

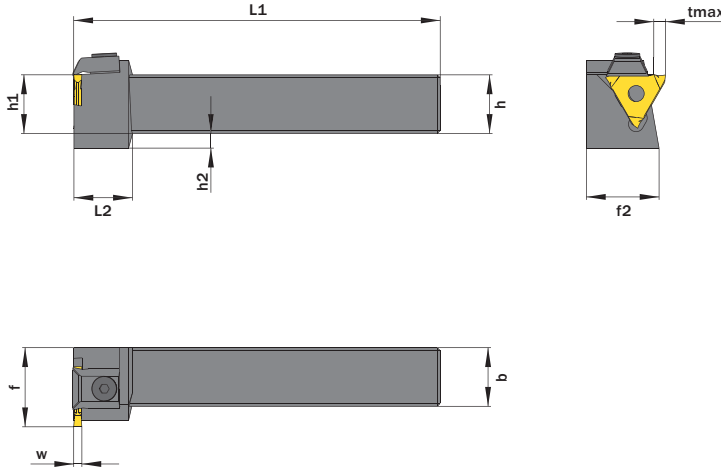

Ød'ye bağlı olarak tmax ölçüleri  
tmax depends on workpiece diameter  
(Ød) tmax  
≤ Ø40,0 mm / ≤ Ø1.5748" 4,0 mm / 0,1575"  
> Ø40,0 mm / > Ø1.5748" 6,0 mm / 0,2362"

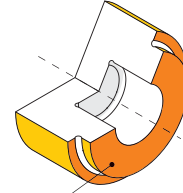

- Öncelikli kullanım alanı  
Mainly designed for these surfaces
- Kullanılan uca göre ekstra kullanım alanı  
Also possible depending on insert/fixation type

Görseldeki çizim/Drawing shows: E69.2020.03 R

h	b	Ürün kodu Part number	Webcode <a href="http://www.simtek.com/webcode">www.simtek.com/webcode</a>	f	f2	h1 <sup>js14</sup>	h2	L1	L2	tmax	w ≥	w ≤	Sıkma Pabucu Clamp	Connectcode <a href="http://www.simtek.com/code">www.simtek.com/code</a>
mm	mm			mm	mm	mm	mm	mm	mm	mm	mm	mm		
▼ h = 20,0 mm														
20,0	20,0	<b>E69.2020.01 R/L</b>	R ANHQ L AATF	27,0	24,5	20,0	5,0	125,0	20,0	4,0	0,5	2,0	E20.1-4	<b>E12.A1</b>
20,0	20,0	<b>E69.2020.02 R/L</b>	R APFK L AGGY	27,0	24,5	20,0	5,0	125,0	20,0	6,0	2,0	3,0	E20.1-4	<b>E12.B2</b>
20,0	20,0	<b>E69.2020.03 R/L</b>	R AKW8 L AH05	27,0	24,5	20,0	5,0	125,0	20,0	6,0	3,0	4,0	E20.1-4	<b>E12.C3</b>
20,0	20,0	<b>E69.2020.04 R/L</b>	R AM7V L AFFX	27,0	24,5	20,0	5,0	125,0	20,0	6,0	4,0	6,3	E20.1-4	<b>E12.D4</b>
▼ h = 25,0 mm														
25,0	25,0	<b>E69.2525.01 R/L</b>	R AJCG L AE5D	32,0	29,5	25,0	-	150,0	-	4,0	0,5	2,0	E20.1-4	<b>E12.A1</b>
25,0	25,0	<b>E69.2525.02 R/L</b>	R ADXZ L AAUK	32,0	29,5	25,0	-	150,0	-	6,0	2,0	3,0	E20.1-4	<b>E12.B2</b>
25,0	25,0	<b>E69.2525.03 R/L</b>	R AE5X L AD8H	32,0	29,5	25,0	-	150,0	-	6,0	3,0	4,0	E20.1-4	<b>E12.C3</b>
25,0	25,0	<b>E69.2525.04 R/L</b>	R AG37 L AFHN	32,0	29,5	25,0	-	150,0	-	6,0	4,0	6,3	E20.1-4	<b>E12.D4</b>

|| Sipariş örneği // Order example: **E69.2020.02 R** (R = Sağ model // Right hand version)

|| Yedek vida // Spare screw: E M6x25 SW3

# İç çap uygulamalar için takım tutucu

İç çap uygulamalar için takım tutucu.

## Toolholder, Internal Applications

Toolholder for internal applications.

Sıkma torku (Vida) // Tightening torque (Screw)

6,0 Nm



Referans  
Legend 37

QR-Code [www.simtek.info/cp/493](http://www.simtek.info/cp/493)  
Tara // Scan veya ziyaret edin // or visit

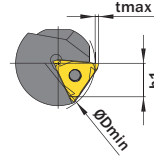
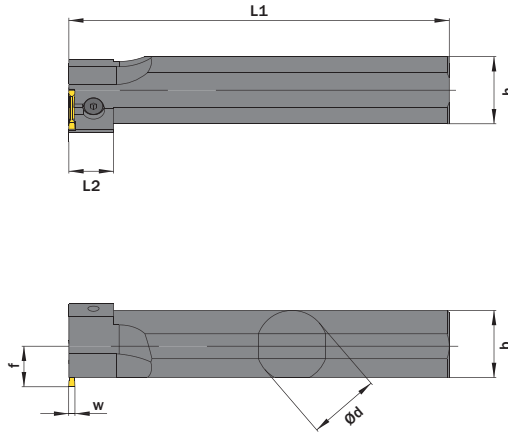

Minimum delik çapı Bore diameter (ØDmin)	tmax
Ø46 mm / Ø1.811"	2,0 mm / 0.078"
Ø50 mm / Ø1.968"	3,0 mm / 0.118"
Ø60 mm / Ø2.362"	4,0 mm / 0.157"
Ø100 mm / Ø3.937"	5,0 mm / 0.196"

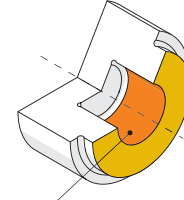

- Öncelikli kullanım alanı  
Mainly designed for these surfaces
- Kullanılan uca göre ekstra kullanım alanı  
Also possible depending on insert type

Görseldeki çizim/Drawing shows: E30.0032.02 R

Ød <sup>g6</sup> mm	Ürün kodu Part number	Webcode <a href="http://www.simtek.com/webcode">www.simtek.com/webcode</a>	b	ØDmin (min. delik) ØDmin (min. bore)	f	h	h1 <sup>js14</sup>	L1	L2	w ≥	w ≤	Sıkma Pabuçu Clamp	Connectcode <a href="http://www.simtek.com/code">www.simtek.com/code</a>
▼ Ød = 25,0 mm													
25,0	E30.0025.01 R/L	R ADSN L AP39	25,0	46,0	19,0	23,0	11,5	170,0	20,0	0,5	2,0	E30.1-4	E12.A1
25,0	E30.0025.02 R/L	R ACMØ L AE7B	25,0	46,0	19,0	23,0	11,5	170,0	20,0	2,0	3,0	E30.1-4	E12.B2
25,0	E30.0025.03 R/L	R AHB6 L AHFE	25,0	46,0	19,0	23,0	11,5	170,0	20,0	3,0	4,0	E30.1-4	E12.C3
25,0	E30.0025.04 R/L	R AADX L ANEW	25,0	46,0	19,0	23,0	11,5	170,0	20,0	4,0	6,3	E30.1-4	E12.D4
▼ Ød = 32,0 mm													
32,0	E30.0032.01 R/L	R AH4Z L AGQB	30,0	46,0	20,0	30,0	15,0	200,0	20,0	0,5	2,0	E30.1-4	E12.A1
32,0	E30.0032.02 R/L	R AK56 L AC57	30,0	46,0	20,0	30,0	15,0	200,0	20,0	2,0	3,0	E30.1-4	E12.B2
32,0	E30.0032.03 R/L	R ADSM L AFS6	30,0	46,0	20,0	30,0	15,0	200,0	20,0	3,0	4,0	E30.1-4	E12.C3
32,0	E30.0032.04 R/L	R ACSM L ACYE	30,0	46,0	20,0	30,0	15,0	200,0	20,0	4,0	6,3	E30.1-4	E12.D4
▼ Ød = 40,0 mm													
40,0	E30.0040.01 R/L	R AGE G L AD3H	38,0	46,0	24,0	38,0	19,0	250,0	-	0,5	2,0	E30.1-4	E12.A1
40,0	E30.0040.02 R/L	R AJ7U L AEP5	38,0	46,0	24,0	38,0	19,0	250,0	-	2,0	3,0	E30.1-4	E12.B2
40,0	E30.0040.03 R/L	R AEK C L ADT8	38,0	46,0	24,0	38,0	19,0	250,0	-	3,0	4,0	E30.1-4	E12.C3
40,0	E30.0040.04 R/L	R ACM3 L AJ7G	38,0	46,0	24,0	38,0	19,0	250,0	-	4,0	6,3	E30.1-4	E12.D4

İ Sipariş örneği // Order example: E30.0025.01 R (R = Sağ model // Right hand version)

İ Yedek vida // Spare screw: E M6x25 SW3

## Dış çap köşe boşaltma uygulamaları için takım tutucu

Dış çap uygulamalarda köşe boşaltma işlemleri için tasarlanmış takım tutucu.

### Toolholder, External, Corner Reliefs

Toolholder for external corner reliefs.

Sıkma torku (Vida) // Tightening torque (Screw)

6,0 Nm



Referans  
Legend 37

QR-Code [www.simtek.info/cp/491](http://www.simtek.info/cp/491)  
Tara // Scan veya ziyaret edin // or visit

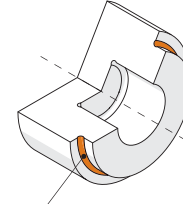
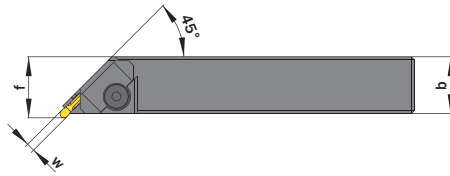
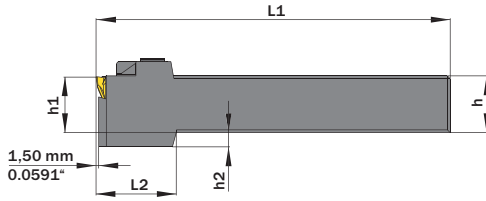

■ Kullanım alanı  
Mainly designed for these surfaces

Görseldeki çizim/Drawing shows: E09.2020.03 R

h	b	Ürün kodu Part number	Webcode <a href="http://www.simtek.com/webcode">www.simtek.com/webcode</a>	f	h1 <sup>js14</sup>	h2	L1	L2	w ≥	w ≤	Sıkma Pabucu Clamp	Connectcode <a href="http://www.simtek.com/code">www.simtek.com/code</a>
mm	mm			mm	mm	mm	mm	mm	mm	mm		
▼ h = 20,0 mm												
20,0	20,0	<b>E09.2020.02 R/L</b>	R AD3B L AB9H	21,5	20,0	5,0	125,0	30,0	1,9	3,0	E09.1.4	E12.A2   E12.B2
20,0	20,0	<b>E09.2020.03 R/L</b>	R AC9H L APDV	21,5	20,0	5,0	125,0	30,0	3,0	4,0	E09.1.4	<b>E12.C3</b>
20,0	20,0	<b>E09.2020.04 R/L</b>	R AK9N L AE7D	21,5	20,0	5,0	125,0	30,0	4,0	6,3	E09.1.4	<b>E12.D4</b>
▼ h = 25,0 mm												
25,0	25,0	<b>E09.2525.02 R/L</b>	R AEZA L ADD1	26,5	25,0	-	150,0	-	1,9	3,0	E09.1.4	E12.A2   E12.B2
25,0	25,0	<b>E09.2525.03 R/L</b>	R AFYU L ABUY	26,5	25,0	-	150,0	-	3,0	4,0	E09.1.4	<b>E12.C3</b>
25,0	25,0	<b>E09.2525.04 R/L</b>	R AJCA L AN1F	26,5	25,0	-	150,0	-	4,0	6,3	E09.1.4	<b>E12.D4</b>
▼ h = 32,0 mm												
32,0	32,0	<b>E09.3232.02 R/L</b>	R AD3N L AMD5	33,5	32,0	-	170,0	-	1,9	3,0	E09.1.4	E12.A2   E12.B2
32,0	32,0	<b>E09.3232.03 R/L</b>	R AJ6X L APZS	33,5	32,0	-	170,0	-	3,0	4,0	E09.1.4	<b>E12.C3</b>
32,0	32,0	<b>E09.3232.04 R/L</b>	R AP4P L APG0	33,5	32,0	-	170,0	-	4,0	6,3	E09.1.4	<b>E12.D4</b>

■ Sipariş örneği // Order example: **E09.2525.02 R** (R = Sağ model // Right hand version)

■ Yedek vida // Spare screw: E M6x25 SW3

## Dış çap uygulamalar için takım tutucu

Traub çift millî makineler için ilk tercih (örn. TNL12).

## Toolholder, External Applications

First choice for Traub double spindle machines (e.g. TNL12).

Sıkma torku (Vida) // Tightening torque (Screw)

4,5 Nm



Referans  
Legend 37

QR-Code [www.simtek.info/cp/1005](http://www.simtek.info/cp/1005)  
Tara // Scan veya ziyaret edin // or visit

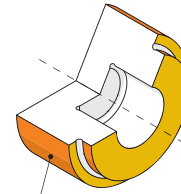
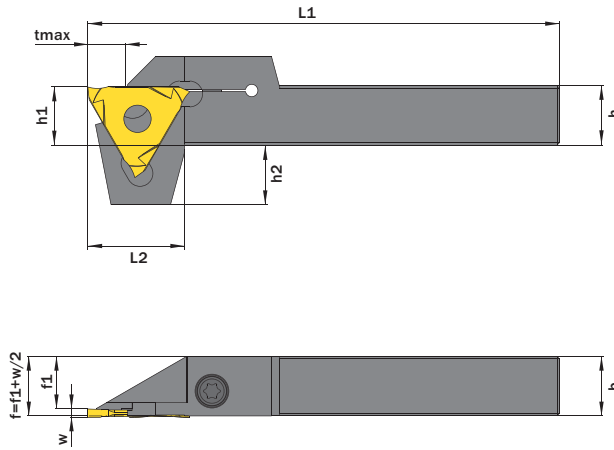

- Öncelikli kullanım alanı  
Mainly designed for these surfaces
- Kullanılan uca göre ekstra kullanım alanı  
Also possible depending on insert/fixation type

Görseldeki çizim/Drawing shows: E68.1212.08 R

h	b	Ürün kodu Part number	Webcode <a href="http://www.simtek.com/webcode">www.simtek.com/webcode</a>	f1	h1 <sup>is14</sup>	h2	L1	L2	tmax	w ≥	w ≤	Vida Screw	Vida anahtarı Screw driver	Connectcode <a href="http://www.simtek.com/ccode">www.simtek.com/ccode</a>
mm	mm			mm	mm	mm	mm	mm	mm	mm	mm			
▼ h = 12,0 mm														
12,0	12,0	<b>E68.1212.08 R/L</b>	R AGVQ L APZ7	11,0	12,0	12,0	95,0	19,5	8,0	0,5	1,5	EM4x12 T15F	T15F	<b>E68.A1</b>
12,0	12,0	<b>E68.1212.11 R/L</b>	R AHGA L ACTS	10,7	12,0	12,0	95,0	19,5	8,0	1,0	2,0	EM4x12 T15F	T15F	<b>E68.A1</b>
▼ h = 16,0 mm														
16,0	16,0	<b>E68.1616.11 R/L</b>	R AE95 L AJXG	14,7	16,0	16,0	95,0	19,5	8,0	0,5	2,0	EM4x12 T15F	T15F	<b>E68.A1</b>

■ Sipariş örneği // Order example: **E68.1212.11 R** (R = Sağ model // Right hand version)

## TOA Modüler takım sistemi için kaset

ISO 26623'e göre tasarlanmış TOA tabanlı takım tutucu uyumlu kaset.

## Cassette for Modular Tool System TOA

For use on SIMTEK base toolholder with polygon shank according to ISO 26623.

Sıkma torku (Vida) // Tightening torque (Screw)

6,0 Nm



Referans  
Legend 37

QR-Code [www.simtek.info/cp/1180](http://www.simtek.info/cp/1180)  
Tara // Scan veya ziyaret edin // or visit

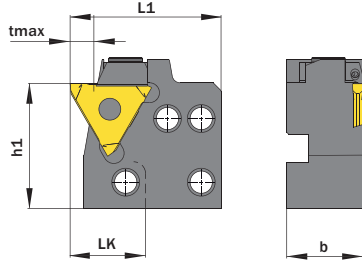

Ød'ye bağlı olarak tmax ölçüleri  
tmax depends on workpiece diameter Ød  
Ød tmax  
< 040,0 mm / ≤ 01.5748" 6,0 mm / 0.2362"

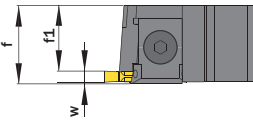

f ve w ölçüleri kesici uca göre değişiklik gösterebilir  
Measures f and w depend on cutting insert

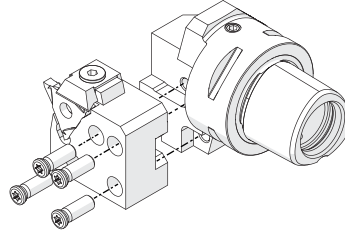

Kaset montajı için vida yerleri  
Screw for cassette mounting  
**T M5x15 T20R**

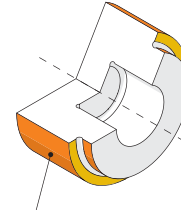

Öncelikli kullanım alanı  
Mainly designed for these surfaces  
Kullanılan uca göre ekstra kullanım alanı  
Also possible depending on insert/fixation type

Görseledeki çizim/Drawing shows: TOA.E60.19.02 R

w ≥	w ≤	Ürün kodu Part number	Webcode <a href="http://www.simtek.com/webcode">www.simtek.com/webcode</a>	b	f1	h1	LK	L1	tmax	Sıkma Pabucu Clamp	Connectcode <a href="http://www.simtek.com/code">www.simtek.com/code</a>	Adaptcode
mm	mm			mm	mm	mm	mm	mm	mm			
▼ Connectcode = E12.A1												
0,5	2,0	<b>TOA.E60.19.01 R/L</b>	R AY99 L AY98	19,2	17,7	31,6	19,0	37,9	6,0	E16.1-4 ICR/L	<b>E12.A1</b>	TOA
▼ Connectcode = E12.A2												
1,0	2,5	<b>TOA.E60.19.23 R/L</b>	R AZAF L AZAE	19,2	17,2	31,6	19,0	37,9	6,0	E16.1-4 ICR/L	<b>E12.A2</b>	TOA
▼ Connectcode = E12.B2												
2,0	3,0	<b>TOA.E60.19.02 R/L</b>	R AZAB L AZAA	19,2	16,7	31,6	19,0	37,9	6,0	E16.1-4 ICR/L	<b>E12.B2</b>	TOA
▼ Connectcode = E12.C3												
3,0	4,0	<b>TOA.E60.19.03 R/L</b>	R AZAD L AZAC	19,2	15,7	31,6	19,0	37,9	6,0	E16.1-4 ICR/L	<b>E12.C3</b>	TOA
▼ Connectcode = E12.D4												
4,0	6,3	<b>TOA.E60.19.04 R/L</b>	R A08W L A08X	19,2	14,0	31,6	19,0	37,9	6,0	E16.1-4 ICR/L	<b>E12.D4</b>	TOA

İ Sipariş örneği // Order example: **TOA.E60.19.03 R** (R = Sağ model // Right hand version)

## Yüksekliği ayarlanabilir kaset

Precium TOG-System uyumlu, yüksekliği ayarlanabilen arka operasyon araçları için kaset.

## Height-Adjust. Cassette for Back Operations

Cassette for height-adjustable back operations tools.  
Compatible to TOG-system by precium.



**TW**  
**ST** Referans  
Legend **37**

QR-Code [www.simtek.info/cp/977](http://www.simtek.info/cp/977)  
Tara // Scan veya ziyaret edin // or visit

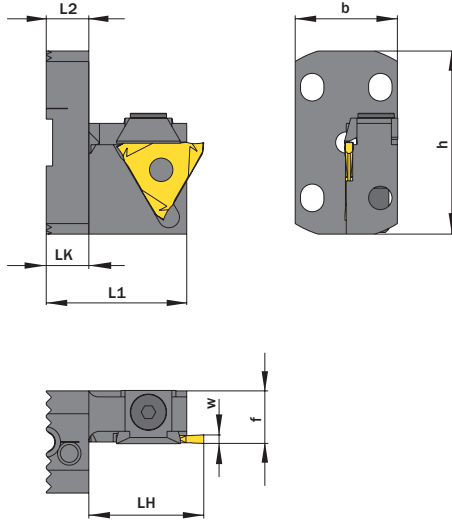

Görseldeki çizim/Drawing shows: TOG.K.E12.C1.01 R

w	Ürün kodu Part number	Webcode <a href="http://www.simtek.com/webcode">www.simtek.com/webcode</a>	b	h	f	L1	L2	LK	LH	Sıkma Pabuçu Clamp	Connectcode <a href="http://www.simtek.com/code">www.simtek.com/code</a>
mm			mm	mm	mm	mm	mm	mm	mm		
1,5	<b>TOG.K.E12.C1.01 R</b>	AT3W	24,0	43,0	12,35	33,0	10,0	10,0	27,0	E12.1-3	<b>E12.A1</b>

■ Sipariş örneği // Order example: **TOG.K.E12.C1.01 R** (R = Sağ model // Right hand version)

■ Yedek vida // Spare screw: E M6x25 SW3

Kanal açma, Segman kanalları,  
İnce genişlik, Azaltılmış kesme derinliği

DIN 471/472 ve DIN 983/984'e göre tasarlanmış segman kanalı uygulamaları için azaltılmış kesme derinliği olan kesici takımlar.

Grooving, Circlip Ring Grooves,  
Slim Widths, With Reduced Cutting DepthCirclip ring grooves comp. to DIN 471/472 and DIN 983/984.  
Reduced cutting depth.

Kesme parametreleri // Cutting parameters (start)

f	Vc
0,04 mm/U	Sayfa/Page 40

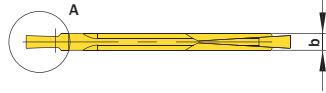
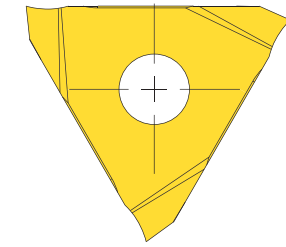
Uyumlu takım tutucu sayfaları // Suitable toolholders on page  
7, 8, 9, 10, 11, 12, 14, 15SP  
HM Referans  
Legend 37QR-Code www.simtek.info/cp/499  
Tara // Scan veya ziyaret edin // or visit

Detay/Detail A

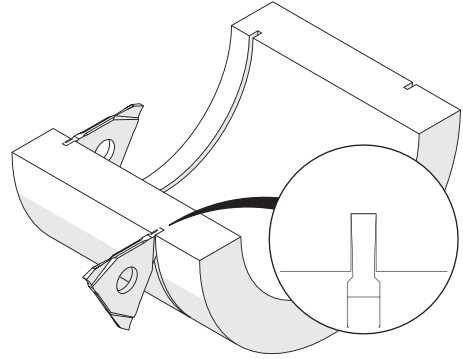
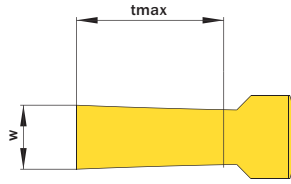

Görseldeki çizim/Drawing shows: E12.1094.00 Z

b ±0,02 mm	Nominal kanal genişliği Nominal width of groove mm	Ürün kodu Part number	Webcode www.simtek.com/webcode	Bizim tavsiyemiz Our first choice P K M N S	tmax mm	w <sup>-0,05</sup> mm	Connectcode www.simtek.com/code
1,3	0,34	E12.1034.00 Z	AHE9	X808 X408	0,6	0,4	E12.A1 E12.A2
1,3	0,44	E12.1044.00 Z	AJAV	X808 X408	0,7	0,5	E12.A1 E12.A2
1,3	0,5	E12.1050.00 Z	ANE0	X808 X408	0,9	0,57	E12.A1 E12.A2
1,3	0,54	E12.1054.00 Z	AHZF	X808 X408	0,8	0,6	E12.A1 E12.A2
1,3	0,6	E12.1060.00 Z	APXN	X808 X408	1,1	0,67	E12.A1 E12.A2
1,3	0,64	E12.1064.00 Z	AC2C	X808 X408	1,0	0,7	E12.A1 E12.A2
1,3	0,7	E12.1070.00 Z	AD4M	X808 X408	1,7	0,77	E12.A1 E12.A2
1,3	0,74	E12.1074.00 Z	ANH3	X808 X408	1,7	0,8	E12.A1 E12.A2
1,3	0,8	E12.1080.00 Z	ADDH	X808 X408	2,3	0,87	E12.A1 E12.A2
1,3	0,85	E12.1085.00 Z	AAUW	X808 X408	2,3	0,91	E12.A1 E12.A2
1,3	0,9	E12.1090.00 Z	ADHX	X808 X408	2,3	0,97	E12.A1 E12.A2
1,3	0,94	E12.1094.00 Z	AMUD	X808 X408	2,3	1,0	E12.A1 E12.A2
1,3	1,0	E12.1100.00 Z	AB93	X808 X408	2,3	1,07	E12.A1 E12.A2
1,3	1,05	E12.1105.00 Z	AH3J	X808 X408	2,3	1,12	E12.A1 E12.A2
1,3	1,1	E12.1115.00 Z	AEHY	X808 X408	2,5	1,22	E12.A1 E12.A2

Sipariş örneği // Order example: E12.1094.00 Z X808 (X808 = Kesici kalitesi // Grade)



## Kanal açma, Segman kanalları, İnce genişlik

DIN 471/472 ve DIN 983/984'e göre tasarlanmış segman kanalı uygulamaları için kesici takımlar.

## Grooving, Circlip Ring Grooves, Slim Widths

Circlip ring grooves comp. to DIN 471/472 and DIN 983/984.

Kesme parametreleri // Cutting parameters (start)

f **0,04 mm/U** Vc **Sayfa/Page 40**

Uyumlu takım tutucu sayfaları // Suitable toolholders on page  
**7, 8, 9, 10, 11, 12, 14, 15**



**SP**  
**HM** Referans  
Legend **37**

QR-Code **www.simtek.info/cp/498**  
Tara // Scan veya ziyaret edin // or visit

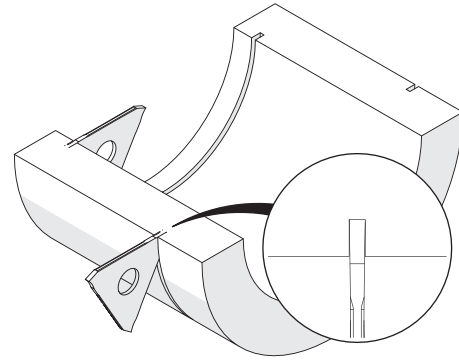
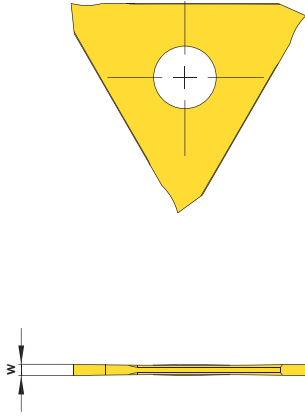

Görseldeki çizim/Drawing shows: E12.0100.00 H

Nominal kanal genişliği Nominal width of groove	Ürün kodu Part number	Webcode www.simtek.com/webcode	Bizim tavsiyemiz Our first choice	w <sup>-0,05</sup> mm	Connectcode www.simtek.com/ccode
mm					
0,5	<b>E12.0050.00 H</b>	AM9A	X808 X408	0,57	<b>E12.A1</b>
0,6	<b>E12.0060.00 H</b>	ABMF	X808 X408	0,67	<b>E12.A1</b>
0,7	<b>E12.0070.00 H</b>	AHDK	X808 X408	0,77	<b>E12.A1</b>
0,8	<b>E12.0080.00 H</b>	AKMH	X808 X408	0,87	<b>E12.A1</b>
0,9	<b>E12.0090.00 H</b>	AA2Z	X808 X408	0,97	<b>E12.A1</b>
1,0	<b>E12.0100.00 H</b>	APFD	X808 X408	1,07	E12.A1   E12.A2

■ Sipariş örneği // Order example: **E12.0100.00 H X808** (X808 = Kesici kalitesi // Grade)

## Kanal açma, Segman kanalları

DIN 471/472 ve DIN 983/984'e göre tasarlanmış segman kanalı uygulamaları için kesici takımlar.

## Grooving, Circlip Ring Grooves

Circlip ring grooves comp. to DIN 471/472 and DIN 983/984.

Kesme parametreleri // Cutting parameters (start)

f	Vc
0,04 mm/U	Sayfa/Page 40

Uyumlu takım tutucu sayfaları // Suitable toolholders on page  
7, 8, 9, 10, 11, 12, 14, 15

SP	Referans	37
HM	Legend	

QR-Code	www.simtek.info/cp/500
Tara // Scan	veya ziyaret edin // or visit

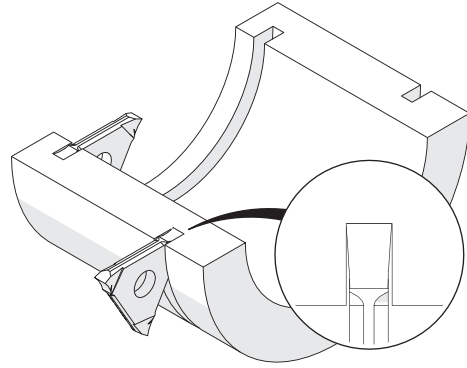
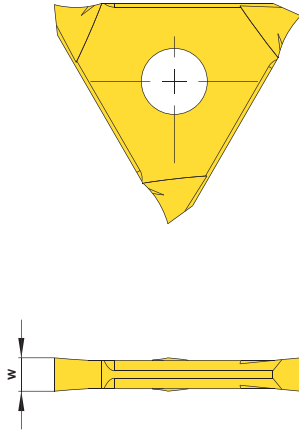

Görseldeki çizim/Drawing shows: E12.0265.00 G

Nominal kanal genişliği Nominal width of groove	Ürün kodu Part number	Webcode www.simtek.com/webcode	Bizim tavsiyemiz Our first choice	w <sup>-0,05</sup> mm	Connectcode www.simtek.com/ccode
mm			P K M N S		
1,1	<b>E12.0110.00 G</b>	AN0Z	X800 X400	1,24	E12.A1 E12.A2
1,3	<b>E12.0130.00 G</b>	AG7C	X800 X400	1,44	E12.A1 E12.A2
1,6	<b>E12.0160.00 G</b>	AE2Y	X800 X400	1,74	E12.A1 E12.A2
1,85	<b>E12.0185.00 G</b>	AMUJ	X800 X400	1,99	E12.A1 E12.A2
2,15	<b>E12.0215.00 G</b>	ANBG	X800 X400	2,29	E12.A2 E12.B2
2,65	<b>E12.0265.00 G</b>	AKPW	X800 X400	2,79	E12.B2
3,15	<b>E12.0315.00 G</b>	AFFJ	X800 X400	3,29	E12.C3
4,15	<b>E12.0415.00 G</b>	AEBD	X800 X400	4,29	E12.D4
5,15	<b>E12.0515.00 G</b>	AJMV	X800 X400	5,29	E12.D4

Sipariş örneği // Order example: **E12.0110.00 G X800** (X800 = Kesici kalitesi // Grade)

simtek individual

E12. w, 1/100 mm, 4 Hane/Digits - R, 1/100 mm, 3 Hane/Digits Tolerans/Tolerance

Örnek ürün kodu/Example Part number: **E12.0156.015 XN**

## Kanal açma

İç ve dış çap kanal açma uygulamaları için tasarlanmış kesici takımlar.

## Grooving

For general grooving.

Kesme parametreleri // Cutting parameters (start)

f	Vc
0,04 mm/U	Sayfa/Page 40

Uyumlu takım tutucu sayfaları // Suitable toolholders on page  
7, 8, 9, 10, 11, 12, 14, 15



SP  
HM Referans  
Legend 37

QR-Code www.simtek.info/cp/1249  
Tara // Scan veya ziyaret edin // or visit

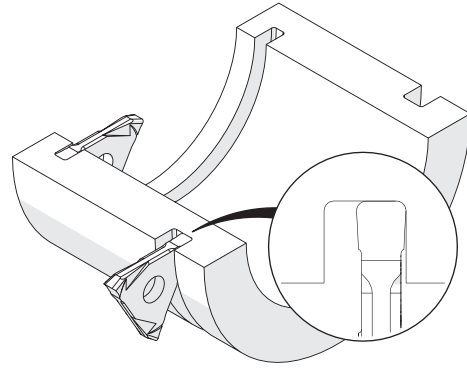
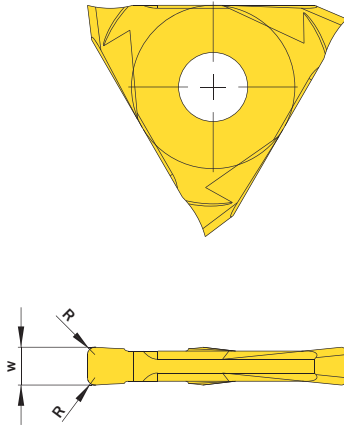

Görseldeki çizim/Drawing shows: E12.0300.06 N

w <sup>+0,02</sup> mm	R mm	Ürün kodu Part number	Webcode www.simtek.com/webcode	Bizim tavsiyemiz Our first choice	Connectcode www.simtek.com/ccode
▼ w = 1,17 mm	-	<b>E12.0117.00 G</b>	AJEW	X800 X400	E12.A1 E12.A2
▼ w = 1,42 mm	-	<b>E12.0142.00 G</b>	AF62	X800 X400	E12.A1 E12.A2
▼ w = 1,58 mm	-	<b>E12.0157.00 G</b>	AC0A	X800 X400	E12.A1 E12.A2
▼ w = 2,4 mm	-	<b>E12.0238.00 G</b>	AFU1	X800 X400	E12.B2
▼ w = 3,18 mm	-	<b>E12.0318.00 G</b>	ADJ8	X800 X400	E12.C3

İ Sipariş örneği // Order example: **E12.0142.00 G X800** (X800 = Kesici kalitesi // Grade)

## Kanal açma, Segman kanalı, Talaş bükücü formlu

DIN 471/472 ve DIN 983/984'e göre tasarlanmış segman kanalı uygulamaları için, talaş bükücü formlu kesici takımlar.

## Grooving, Circlip Ring Grooves, With Ground Chip Form Channel

Circlip ring grooves comp. to DIN 471/472 and DIN 983/984.  
With ground chip form channel.

Kesme parametreleri // Cutting parameters (start)

f	Vc
0,08 mm/U	Sayfa/Page 40

Uyumlu takım tutucu sayfaları // Suitable toolholders on page  
7, 8, 9, 10, 11, 12, 14, 15



SP  
HM Referans  
Legend 37

QR-Code www.simtek.info/cp/503  
Tara // Scan veya ziyaret edin // or visit

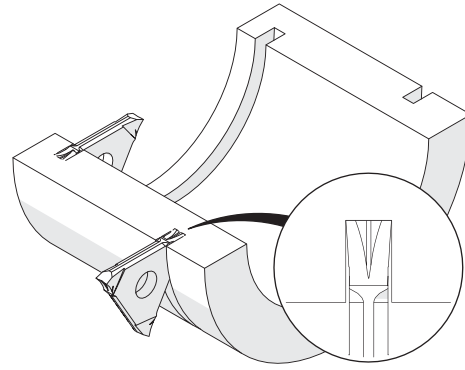
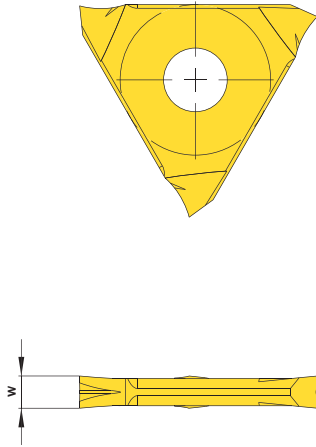

Görseldeki çizim/Drawing shows: E12.0265.11 K

Nominal kanal genişliği Nominal width of groove	Ürün kodu Part number	Webcode www.simtek.com/webcode	Bizim tavsiyemiz Our first choice	w <sup>-0,05</sup> mm	Connectcode www.simtek.com/ccode
mm					
1,1	<b>E12.0110.11 K</b>	AJBT	X800 X400	1,24	E12.A1 E12.A2
1,3	<b>E12.0130.11 K</b>	AJJ3	X800 X400	1,44	E12.A1 E12.A2
1,6	<b>E12.0160.11 K</b>	ACKU	X800 X400	1,74	E12.A1 E12.A2
1,85	<b>E12.0185.11 K</b>	AK7B	X800 X400	1,99	E12.A1 E12.A2
2,15	<b>E12.0215.11 K</b>	AH5U	X800 X400	2,29	E12.A2 E12.B2
2,65	<b>E12.0265.11 K</b>	AH76	X800 X400	2,79	<b>E12.B2</b>
3,15	<b>E12.0315.11 K</b>	AE79	X800 X400	3,29	<b>E12.C3</b>

■ Sipariş örneği // Order example: **E12.0185.11 K X800** (X800 = Kesici kalitesi // Grade)

## Kanal açma, Segman kanalları, 0° Talaş yüzeyi

DIN 471/472 ve DIN 983/984'e göre tasarlanmış segman kanal uygulamaları için 0° talaş yüzeyli kesici takımlar.

## Grooving, Circlip Ring Grooves, With 0° Rake Angle

Circlip ring grooves comp. to DIN 471/472 and DIN 983/984.  
With 0° rake angle.

Kesme parametreleri // Cutting parameters (start)

f	Vc
0,04 mm/U	Sayfa/Page 40

Uyumlu takım tutucu sayfaları // Suitable toolholders on page  
7, 8, 9, 10, 11, 12, 14, 15



SP  
HM Referans  
Legend 37

QR-Code www.simtek.info/cp/502  
Tara // Scan veya ziyaret edin // or visit

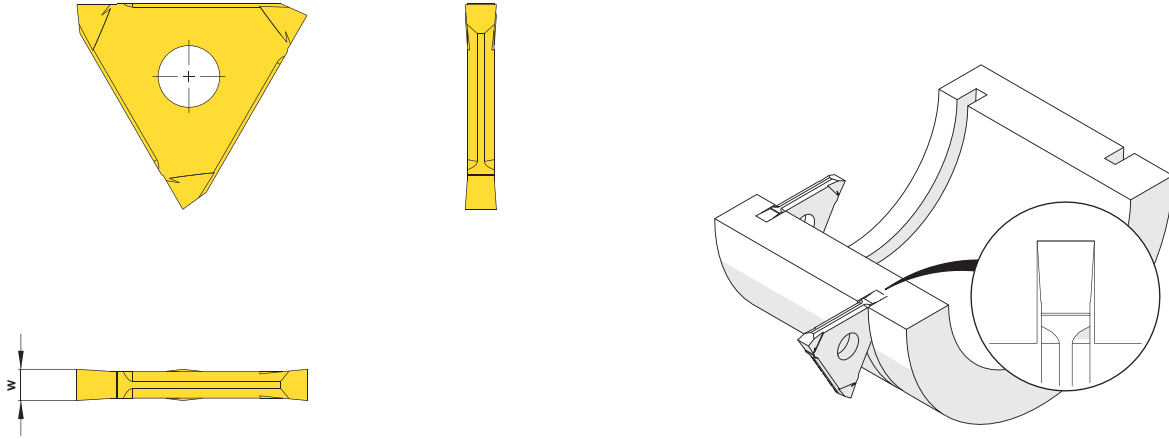

Görseldeki çizim/Drawing shows: E12.0265.00 GU

Nominal kanal genişliği Nominal width of groove	Ürün kodu Part number	Webcode www.simtek.com/webcode	Bizim tavsiyemiz Our first choice	w <sup>-0,05</sup> mm	Connectcode www.simtek.com/ccode
mm					
1,1	<b>E12.0110.00 GU</b>	AAEQ	X808 X408	1,24	E12.A1 E12.A2
1,3	<b>E12.0130.00 GU</b>	AFC2	X808 X408	1,44	E12.A1 E12.A2
1,6	<b>E12.0160.00 GU</b>	AK23	X808 X408	1,74	E12.A1 E12.A2
1,85	<b>E12.0185.00 GU</b>	ABVN	X808 X408	1,99	E12.A1 E12.A2
2,15	<b>E12.0215.00 GU</b>	AMH2	X808 X408	2,29	E12.A2 E12.B2
2,65	<b>E12.0265.00 GU</b>	ABGY	X808 X408	2,79	E12.B2
3,15	<b>E12.0315.00 GU</b>	AE6N	X808 X408	3,29	E12.C3
4,15	<b>E12.0415.00 GU</b>	AGP6	X808 X408	4,29	E12.D4
5,15	<b>E12.0515.00 GU</b>	AC2Q	X808 X408	5,29	E12.D4

İ Sipariş örneği // Order example: **E12.0130.00 GU X808** (X808 = Kesici kalitesi // Grade)

## Kanal açma, Segman kanalları, Yüksek pozitif talaş yüzeyi açısı

DIN 471/472 ve DIN 983/984'e göre tasarlanmış segman kanalı uygulamaları için, özellikle hafif alaşımlar için yüksek pozitif talaş yüzeyli kesici takımlar.

## Grooving, Circlip Ring Grooves, With High Positive Rake Angle

Circlip ring grooves comp. to DIN 471/472 and DIN 983/984.  
With high positive rake angle, especially for light alloys.

Kesme parametreleri // Cutting parameters (start)

f	Vc
0,04 mm/U	Sayfa/Page 40

Uyumlu takım tutucu sayfaları // Suitable toolholders on page  
7, 8, 9, 10, 11, 12, 14, 15



SP  
HM LM Referans 37  
Legend

QR-Code www.simtek.info/cp/501  
Tara // Scan veya ziyaret edin // or visit

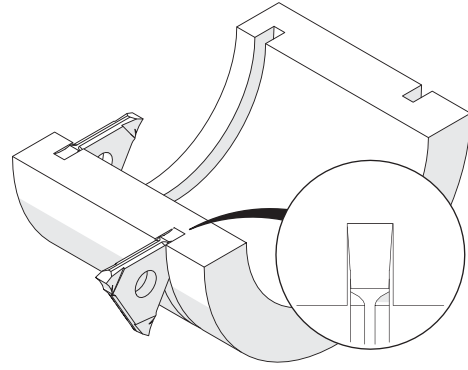
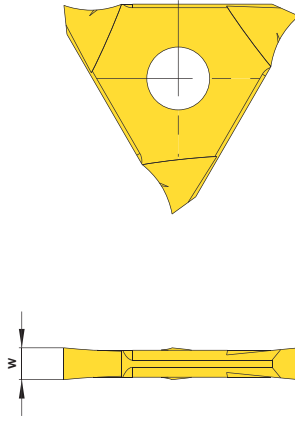

Görseldeki çizim/Drawing shows: E12.0265.40 C

Nominal kanal genişliği Nominal width of groove	Ürün kodu Part number	Webcode www.simtek.com/webcode	Bizim tavsiyemiz Our first choice	w <sup>-0,05</sup> mm	Connectcode www.simtek.com/ccode
mm			P K M N S		
1,1	<b>E12.0110.40 C</b>	AGD1	X808 X408	1,24	E12.A1 E12.A2
1,3	<b>E12.0130.40 C</b>	AA6C	X808 X408	1,44	E12.A1 E12.A2
1,6	<b>E12.0160.40 C</b>	AGFW	X808 X408	1,74	E12.A1 E12.A2
1,85	<b>E12.0185.40 C</b>	ACVX	X808 X408	1,99	E12.A1 E12.A2
2,15	<b>E12.0215.40 C</b>	AENS	X808 X408	2,29	E12.A2 E12.B2
2,65	<b>E12.0265.40 C</b>	AFXA	X808 X408	2,79	E12.B2
3,15	<b>E12.0315.40 C</b>	AA3S	X808 X408	3,29	E12.C3
4,15	<b>E12.0415.40 C</b>	AK3D	X808 X408	4,29	E12.D4
5,15	<b>E12.0515.40 C</b>	AM1M	X808 X408	5,29	E12.D4

|| Sipariş örneği // Order example: **E12.0160.40 C X808** (X808 = Kesici kalitesi // Grade)

## Kanal açma, Pahlı segman kanalları

DIN 471/472 ve DIN 983/984'e göre tasarlanmış pahlı segman kanalı uygulamaları için kesici takımlar.

## Grooving, Circlip Ring Grooves With Chamfer

Circlip ring grooves comp. to DIN 471/472 and DIN 983/984, with chamfer.

Kesme parametreleri // Cutting parameters (start)

f	Vc
0,04 mm/U	Sayfa/Page 40

Uyumlu takım tutucu sayfaları // Suitable toolholders on page  
7, 8, 9, 10, 11, 12, 14



SP  
HM Referans  
Legend 37

QR-Code www.simtek.info/cp/504  
Tara // Scan veya ziyaret edin // or visit

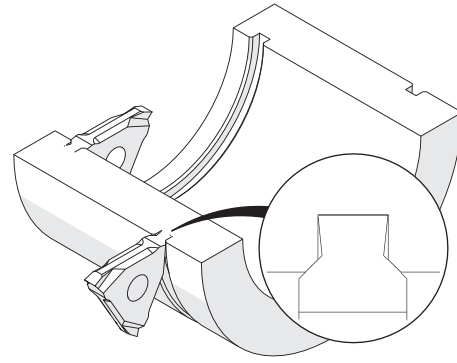
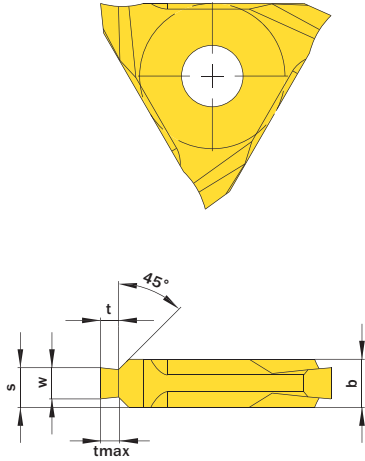

Nominal kanal genişliği Nominal width of groove	tmax	b ±0,02	Ürün kodu Part number	Webcode www.simtek.com/webcode	Bizim tavsiyemiz Our first choice	S	t	w <sup>-0,05</sup>	Connectcode www.simtek.com/ccode
mm	mm	mm			P K M N S	mm	mm	mm	
▼ Nominal kanal genişliği // Nominal width of groove = 1,1 mm									
1,1	0,25	2,5	<b>E12.1102.25 F</b>	ACC7	X800 X400	1,88	0,24	1,24	E12.A2 E12.B2
1,1	0,3	2,5	<b>E12.1103.25 F</b>	AC0T	X800 X400	1,88	0,29	1,24	E12.A2 E12.B2
1,1	0,35	2,5	<b>E12.1104.25 F</b>	AE1Y	X800 X400	1,88	0,33	1,24	E12.A2 E12.B2
1,1	0,4	2,5	<b>E12.1105.25 F</b>	AJ1V	X800 X400	1,88	0,36	1,24	E12.A2 E12.B2
▼ Nominal kanal genişliği // Nominal width of groove = 1,3 mm									
1,3	0,55	2,5	<b>E12.1306.25 F</b>	ACN1	X800 X400	1,98	0,45	1,44	E12.A2 E12.B2
▼ Nominal kanal genişliği // Nominal width of groove = 1,6 mm									
1,6	0,7	3,3	<b>E12.1607.33 F</b>	AJY0	X800 X400	2,53	0,6	1,74	E12.C3
1,6	0,85	3,3	<b>E12.1608.33 F</b>	AF23	X800 X400	2,53	0,75	1,74	E12.C3
1,6	1,0	3,3	<b>E12.1609.33 F</b>	AM03	X800 X400	2,53	0,85	1,74	E12.C3
▼ Nominal kanal genişliği // Nominal width of groove = 1,85 mm									
1,85	1,0	3,3	<b>E12.1810.33 F</b>	AD4J	X800 X400	2,66	0,85	1,99	E12.C3
1,85	1,25	3,3	<b>E12.1812.33 F</b>	APZ1	X800 X400	2,66	1,1	1,99	E12.C3
▼ Nominal kanal genişliği // Nominal width of groove = 2,15 mm									
2,15	1,5	4,3	<b>E12.2115.43 F</b>	AK5Q	X800 X400	3,31	1,35	2,29	E12.D4

Benzer takımları bir sonraki sayfada bulabilirsiniz!  
Related Items can be found on the following page as well!

Tablonun Devamı  
Continued Table

İ Sipariş örneği // Order example: **E12.1812.33 F X800** (X800 = Kesici kalitesi // Grade)

## Kanal açma, Pahlı segman kanalları

DIN 471/472 ve DIN 983/984'e göre tasarlanmış pahlı segman kanalı uygulamaları için kesici takımlar.

## Grooving, Circlip Ring Grooves With Chamfer

Circlip ring grooves comp. to DIN 471/472 and DIN 983/984, with chamfer.

Kesme parametreleri // Cutting parameters (start)

f	Vc
0,04 mm/U	Sayfa/Page 40

Uyumlu takım tutucu sayfaları // Suitable toolholders on page  
7, 8, 9, 10, 11, 12, 14



SP  
HM Referans  
Legend 37

QR-Code www.simtek.info/cp/514  
Tara // Scan veya ziyaret edin // or visit

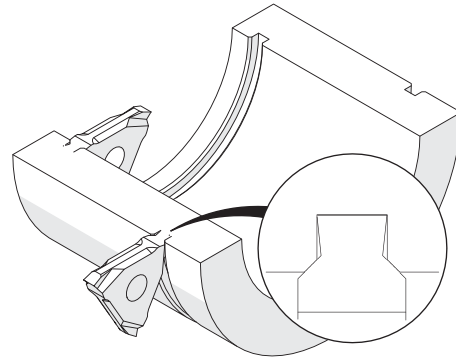
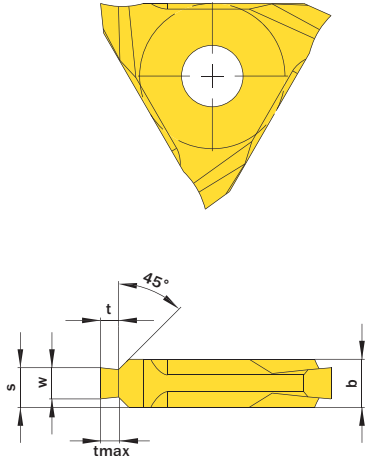

Nominal kanal genişliği Nominal width of groove	tmax	b ±0,02	Ürün kodu Part number	Webcode www.simtek.com/webcode	Bizim tavsiyemiz Our first choice	S	t	w <sup>-0,05</sup>	Connectcode www.simtek.com/ccode
mm	mm	mm			P K M N S	mm	mm	mm	

Tablonun Devamı  
Continued Table

Benzer takımları bir önceki sayfada bulabilirsiniz!  
Related items can be found on the following page as well!

▼ Nominal kanal genişliği // Nominal width of groove = 2,65 mm									
2,65	1,5	3,3	<b>E12.2516.33 F</b>	AGJG	X800 X400	3,06	1,35	2,79	E12.C3
2,65	1,5	4,3	<b>E12.2616.43 F</b>	ABGF	X800 X400	3,56	1,35	2,79	E12.D4
2,65	1,75	4,3	<b>E12.2617.43 F</b>	AKMC	X800 X400	3,56	1,6	2,79	E12.D4
▼ Nominal kanal genişliği // Nominal width of groove = 3,15 mm									
3,15	1,75	5,3	<b>E12.3118.53 F</b>	AKWW	X800 X400	4,31	1,6	3,29	E12.D4
▼ Nominal kanal genişliği // Nominal width of groove = 4,15 mm									
4,15	2,0	5,3	<b>E12.4120.53 F</b>	AFQG	X800 X400	4,81	1,85	4,29	E12.D4
4,15	2,5	5,3	<b>E12.4125.53 F</b>	APSU	X800 X400	4,81	2,35	4,29	E12.D4
▼ Nominal kanal genişliği // Nominal width of groove = 5,15 mm									
5,15	3,0	6,3	<b>E12.5130.63 F</b>	AK6G	X800 X400	5,81	2,85	5,29	E12.D4

|| Sipariş örneği // Order example: **E12.4125.53 F X800** (X800 = Kesici kalitesi // Grade)



## Kanal açma ve Profil tornalama

CNC profil tornalama uygulamaları için kesici takımlar.

## Grooving and Profiling

CNC profiling.

Kesme parametreleri // Cutting parameters (start)

f	Vc
0,04 mm/U	Sayfa/Page 40

Uyumlu takım tutucu sayfaları // Suitable toolholders on page  
7, 8, 9, 10, 11, 12, 14, 15



Referans Legend 37

QR-Code www.simtek.info/cp/506  
Tara // Scan veya ziyaret edin // or visit

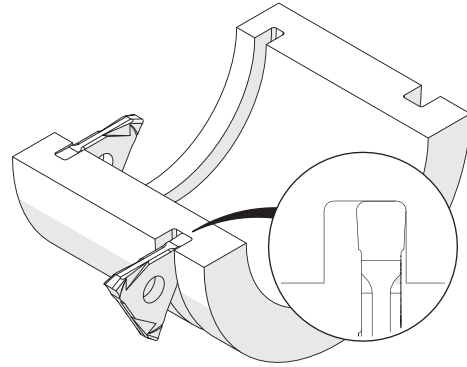
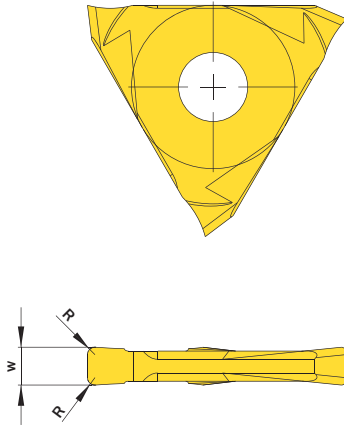

Görseldeki çizim/Drawing shows: E12.0300.06 N

w <sup>+0,03</sup> mm	R mm	Ürün kodu Part number	Webcode www.simtek.com/webcode	Bizim tavsiyemiz Our first choice	Connectcode www.simtek.com/code
▼ w = 1,0 mm				P K M N S	
1,0	0,05	<b>E12.0100.00 N</b>	AMFH	X800 X400	E12.A1 E12.A2
1,0	0,2	<b>E12.0100.02 N</b>	AP31	X800 X400	E12.A1 E12.A2
▼ w = 1,5 mm					
1,5	0,05	<b>E12.0150.00 N</b>	AKVM	X800 X400	E12.A1 E12.A2
1,5	0,2	<b>E12.0150.02 N</b>	AEWQ	X800 X400	E12.A1 E12.A2
▼ w = 2,0 mm					
2,0	0,05	<b>E12.0200.00 N</b>	AEVK	X800 X400	E12.A1 E12.A2
2,0	0,2	<b>E12.0200.02 N</b>	AB41	X800 X400	E12.A1 E12.A2
2,0	0,4	<b>E12.0200.04 N</b>	AFS9	X800 X400	E12.A1 E12.A2
▼ w = 2,5 mm					
2,5	0,05	<b>E12.0250.00 N</b>	AG51	X800 X400	E12.A2 E12.B2
2,5	0,2	<b>E12.0250.02 N</b>	AGZ8	X800 X400	E12.A2 E12.B2
2,5	0,4	<b>E12.0250.04 N</b>	AECQ	X800 X400	E12.A2 E12.B2

Benzer takımları bir sonraki sayfada bulabilirsiniz!  
Related Items can be found on the following page as well!

Tablonun Devamı  
Continued Table

Sipariş örneği // Order example: **E12.0100.00 N X800** (X800 = Kesici kalitesi // Grade)

simtek individual

E12. w, 1/100 mm, 4 Hane/Digits - R, 1/100 mm, 3 Hane/Digits Tolerans/Tolerance

Örnek ürün kodu/Example Part number: **E12.0156.015 XN**

## Kanal açma ve Profil tornalama

CNC profil tornalama uygulamaları için kesici takımlar.

## Grooving and Profiling

CNC profiling.

Kesme parametreleri // Cutting parameters (start)

f	Vc
0,04 mm/U	Sayfa/Page 40

Uyumlu takım tutucu sayfaları // Suitable toolholders on page  
7, 8, 9, 10, 11, 12, 14



SP  
HM Referans  
Legend 37

QR-Code www.simtek.info/cp/865  
Tara // Scan veya ziyaret edin // or visit

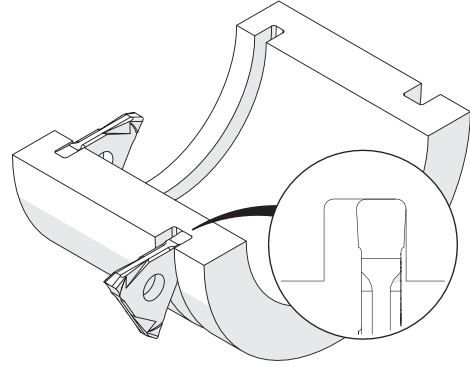
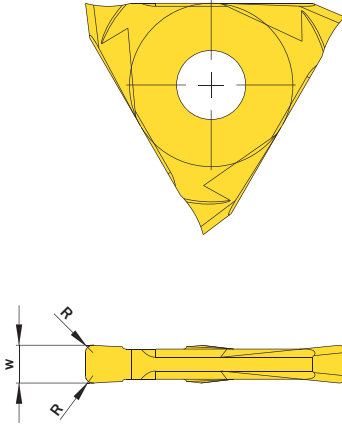

Görseldeki çizim/Drawing shows: E12.0300.06 N

w <sup>+0,03</sup> mm	R mm	Ürün kodu Part number	Webcode www.simtek.com/webcode	Bizim tavsiyemiz Our first choice P K M N S	Connectcode www.simtek.com/code
--------------------------	---------	--------------------------	-----------------------------------	---	------------------------------------

Tablonun Devamı  
Continued Table

Benzer takımları bir önceki sayfada bulabilirsiniz!  
Related items can be found on the following page as well!

▼ w = 3,0 mm

3,0	0,05	E12.0300.00 N	AGUD	X800 X400	E12.B2
3,0	0,2	E12.0300.02 N	ABEQ	X800 X400	E12.B2
3,0	0,4	E12.0300.04 N	AA6U	X800 X400	E12.B2
3,0	0,6	E12.0300.06 N	AMZM	X800 X400	E12.B2
3,0	0,8	E12.0300.08 N	AJV3	X800 X400	E12.B2

▼ w = 4,0 mm

4,0	0,05	E12.0400.00 N	AP2K	X800 X400	E12.C3
4,0	0,2	E12.0400.02 N	ADXN	X800 X400	E12.C3
4,0	0,4	E12.0400.04 N	AFJK	X800 X400	E12.C3
4,0	0,8	E12.0400.08 N	AJPØ	X800 X400	E12.C3
4,0	1,2	E12.0400.12 N	AKU8	X800 X400	E12.C3

! Sipariş örneği // Order example: E12.0300.06 N X800 (X800 = Kesici kalitesi // Grade)

simtek individual

E12. w, 1/100 mm, 4 Hane/Digits - R, 1/100 mm, 3 Hane/Digits Tolerans/Tolerance  
Örnek ürün kodu/Example Part number: E12.0156.015 XN

## Kanal açma ve Tornalama, İkili talaş bükücü formlu

Dış çap kanal açma ve tornalama uygulamalarında,  
ikili talaş bükücü formlu kesici takımlar.

## Grooving and Turning, Two Ground Chip Form Channels

Grooving and turning, external. With two ground chip form channels.

Kesme parametreleri // Cutting parameters (start)

f	Vc
0,08 mm/U	Sayfa/Page 40

Uyumlu takım tutucu sayfaları // Suitable toolholders on page  
7, 8, 9, 10, 11, 12, 14



SP  
HM Referans  
Legend 37

QR-Code www.simtek.info/cp/505  
Tara // Scan veya ziyaret edin // or visit

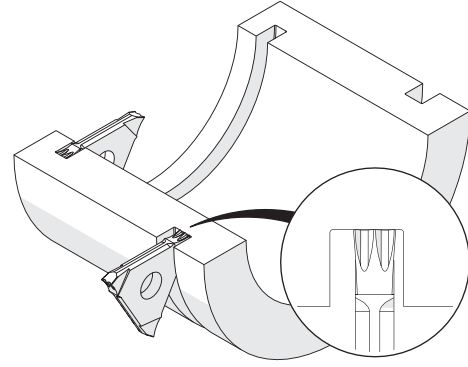
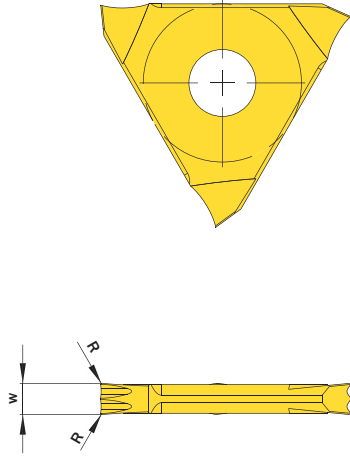

Görseldeki çizim/Drawing shows: E12.0025.44 W

w <sup>-0,05</sup>	Ürün kodu Part number	Webcode www.simtek.com/webcode	Bizim tavsiyemiz Our first choice	R	Connectcode www.simtek.com/code
mm	E12.0025.44 W	AHYP	P K M N S	mm	E12.A2   E12.B2
2,5			X800 X400	0,2	

■ Sipariş örneği // Order example: E12.0025.44 W X800 (X800 = Kesici kalitesi // Grade)

## Kanal açma ve Profil tornalama, Full Radius

CNC profil tornalama uygulamaları için full radius kesici takımlar.

## Grooving and Profiling, Full Radius

Full radius, CNC profiling.

Kesme parametreleri // Cutting parameters (start)

f	Vc
0,04 mm/U	Sayfa/Page 40

Uyumlu takım tutucu sayfaları // Suitable toolholders on page  
7, 8, 9, 10, 11, 12, 14, 15



SP  
HM Referans  
Legend 37

QR-Code www.simtek.info/cp/507  
Tara // Scan veya ziyaret edin // or visit

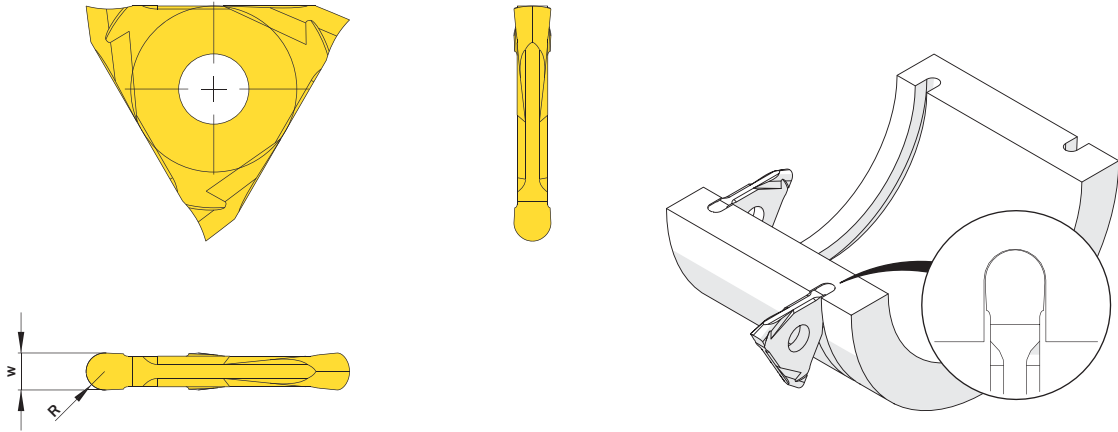

Görseldeki çizim/Drawing shows: E12.0300.15 V

$w^{+0,04}$	R	Ürün kodu Part number	Webcode www.simtek.com/webcode	Bizim tavsiyemiz Our first choice	Connectcode www.simtek.com/code
mm	mm			P K M N S	
1,0	0,5	<b>E12.0100.05 V</b>	ADKV	X800 X400	E12.A1 E12.A2
1,2	0,6	<b>E12.0120.06 V</b>	AKTC	X800 X400	E12.A1 E12.A2
1,5	0,75	<b>E12.0150.07 V</b>	AMYT	X800 X400	E12.A1 E12.A2
2,0	1,0	<b>E12.0200.10 V</b>	AFZA	X800 X400	E12.A1 E12.A2
2,4	1,19	<b>E12.0238.12 V</b>	A1PG	X800 X400	E12.A1 E12.A2
2,5	1,25	<b>E12.0250.12 V</b>	AH44	X800 X400	E12.A2 E12.B2
3,0	1,5	<b>E12.0300.15 V</b>	AAW2	X800 X400	E12.B2
4,0	2,0	<b>E12.0400.20 V</b>	AFGY	X800 X400	E12.C3

|| Sipariş örneği // Order example: **E12.0150.07 V X800** (X800 = Kesici kalitesi // Grade)

## Köşe boşaltma, Kanal açma, Full radius

Köşe boşaltma ve kanal açma uygulamaları için full radius kesici takımlar.

## Corner Relief, Grooving, Full Radius

Corner relief, full radius with increased lateral relief angles.

Kesme parametreleri // Cutting parameters (start)

f	Vc
0,04 mm/U	Sayfa/Page 40

Uyumlu takım tutucu sayıları // Suitable toolholders on page  
7, 8, 9, 10, 11, 12, 14, 15



SP  
HM Referans  
Legend 37

QR-Code www.simtek.info/cp/508  
Tara // Scan veya ziyaret edin // or visit

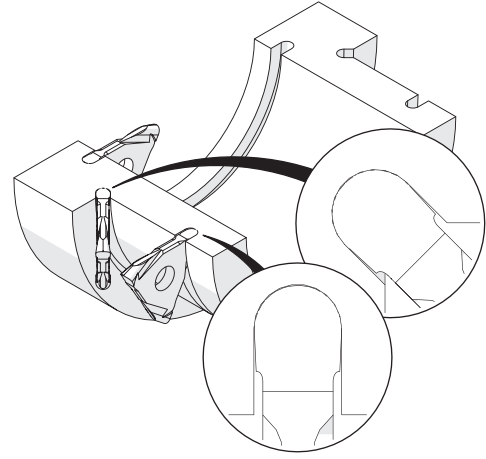
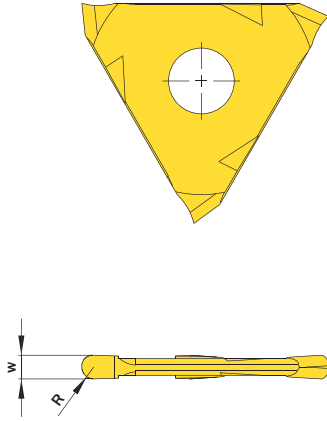

Görseldeki çizim/Drawing shows: E12.0010.20 V

R	w $\pm 0,03$	Ürün kodu Part number	Webcode www.simtek.com/webcode	Bizim tavsiyemiz Our first choice	Connectcode www.simtek.com/ccode
mm	mm			P K M N S	
1,0	2,0	<b>E12.0010.20 V</b>	AGXF	X800 X400	E12.A1 E12.A2
1,2	2,4	<b>E12.0012.24 V</b>	AM15	X800 X400	E12.A2 E12.B2
1,5	3,0	<b>E12.0015.30 V</b>	APVW	X800 X400	E12.B2
2,0	4,0	<b>E12.0020.40 V</b>	ANJ2	X800 X400	E12.C3
2,5	5,0	<b>E12.0025.50 V</b>	AHJ2	X800 X400	E12.D4
3,0	6,0	<b>E12.0030.60 V</b>	AJ0T	X800 X400	E12.D4

■ Sipariş örneği // Order example: **E12.0012.24 V X800** (X800 = Kesici kalitesi // Grade)

## Kanal açma, Yuvarlak telli Segman

DIN 7993'e göre tasarlanmış yuvarlak telli geçmeli segman kanalı uygulamaları için kesici takımlar.

## Grooving, Round-Wire Snap-Ring

Round-wire snap-ring, comparing to DIN 7993.

Kesme parametreleri // Cutting parameters (start)

f	Vc
0,04 mm/U	Sayfa/Page 40

Uyumlu takım tutucu sayfaları // Suitable toolholders on page  
7, 8, 9, 10, 11, 12, 14, 15



SP  
HM Referans  
Legend 37

QR-Code www.simtek.info/cp/497  
Tara // Scan veya ziyaret edin // or visit

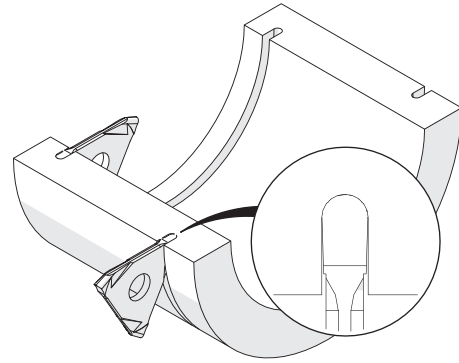
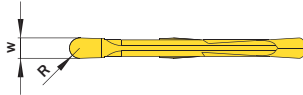
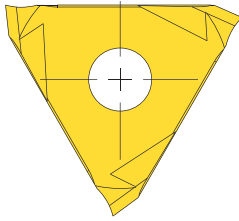

Görseldeki çizim/Drawing shows: E12.0009.00 V

R	Ürün kodu Part number	Webcode www.simtek.com/webcode	Bizim tavsiyemiz Our first choice	w ±0,03	Connectcode www.simtek.com/ccode
mm			P K M N S	mm	
0,8	<b>E12.0008.00 V</b>	AAUG	X800 X400	1,6	E12.A1 E12.A2
0,9	<b>E12.0009.00 V</b>	AGCW	X800 X400	1,8	E12.A1 E12.A2
1,1	<b>E12.0011.00 V</b>	AM8P	X800 X400	2,2	E12.A2 E12.B2
1,4	<b>E12.0014.00 V</b>	AG9V	X800 X400	2,8	E12.B2
1,8	<b>E12.0018.00 V</b>	ABHS	X800 X400	3,6	E12.C3

■ Sipariş örneği // Order example: **E12.0008.00 V X800** (X800 = Kesici kalitesi // Grade)

## Kanal açma, İnce yuvarlak telli segman

DIN 7993'e göre tasarlanmış yuvarlak telli geçmeli segman kanalı uygulamaları için kesici takımlar.

## Grooving, Slim Round-Wire Snap-Ring

Round-wire snap-ring, comparing to DIN 7993.

Kesme parametreleri // Cutting parameters (start)

f	Vc
0,04 mm/U	Sayfa/Page 40

Uyumlu takım tutucu sayfaları // Suitable toolholders on page  
7, 8, 9, 10, 11, 12, 14, 15



SP  
HM Referans  
Legend 37

QR-Code www.simtek.info/cp/496  
Tara // Scan veya ziyaret edin // or visit

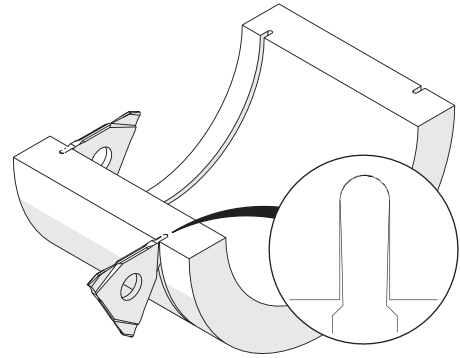
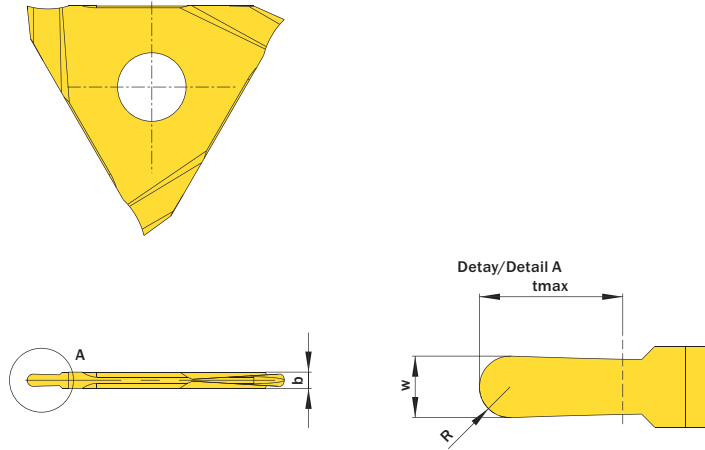

Görseldeki çizim/Drawing shows: E12.1305.00 V

b ±0,02	R	Ürün kodu Part number	Webcode www.simtek.com/webcode	Bizim tavsiyemiz Our first choice	tmax	w ±0,03	Connectcode www.simtek.com/ccode
mm	mm			P K M N S	mm	mm	
1,3	0,2	<b>E12.1302.00 V</b>	AMYV	X800 X400	0,6	0,4	E12.A1 E12.A2
1,3	0,25	<b>E12.1302.05 V</b>	A2WD	X800 X400	0,85	0,5	E12.A1 E12.A2
1,3	0,3	<b>E12.1303.00 V</b>	AC92	X800 X400	1,1	0,6	E12.A1 E12.A2
1,3	0,4	<b>E12.1304.00 V</b>	AA2Q	X800 X400	1,8	0,8	E12.A1 E12.A2
1,3	0,5	<b>E12.1305.00 V</b>	AMD3	X800 X400	2,3	1,0	E12.A1 E12.A2
1,3	0,6	<b>E12.1306.00 V</b>	AN0T	X800 X400	2,5	1,2	E12.A1 E12.A2

■ Sipariş örneği // Order example: **E12.1305.00 V X800** (X800 = Kesici kalitesi // Grade)

## Dış sonu boşaltma

DIN 76 profil B'ye uygun, dış sonu boşaltma uygulamaları için tasarlanmış kesici takımlar.

## Thread Reliefs

Thread reliefs, comp. to DIN 76 profil B.

Kesme parametreleri // Cutting parameters (start)

f	Vc
0,04 mm/U	Sayfa/Page 40

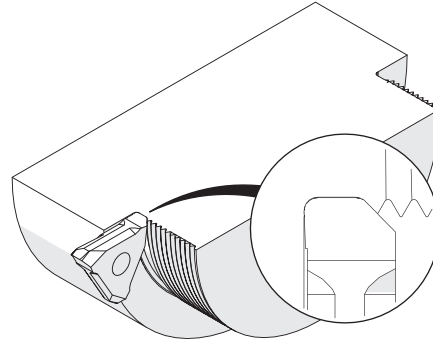
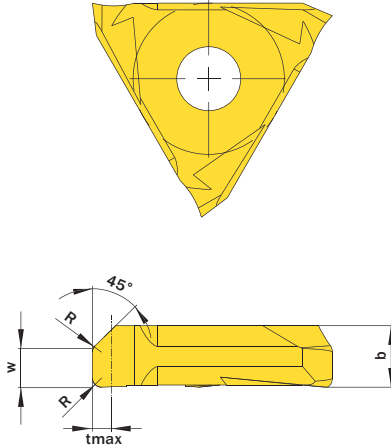
Uyumlu takım tutucu sayfaları // Suitable toolholders on page  
7, 8, 9, 10, 11, 12, 14, 15Referans  
Legend 37QR-Code [www.simtek.info/cp/873](http://www.simtek.info/cp/873)  
Tara // Scan veya ziyaret edin // or visit

Görseldeki çizim/Drawing shows: E12.3150.53 E R

Adım (minimum) Pitch (as of)	b	Ürün kodu Part number	Webcode <a href="http://www.simtek.com/webcode">www.simtek.com/webcode</a>	Bizim tavsiyemiz Our first choice	R	tmax	w	Connectcode <a href="http://www.simtek.com/ccode">www.simtek.com/ccode</a>
mm	mm			P K M N S	mm	mm	mm	
▼ Adım (minimum) // Pitch (as of) = 0,5 mm								
0,5	1,7	<b>E12.1050.17 E R/L</b>	R AKSN L AF3B X800 X400		0,2	0,4	0,6	E12.A1 E12.A2
▼ Adım (minimum) // Pitch (as of) = 0,8 mm								
0,8	2,7	<b>E12.1080.27 E R/L</b>	R AATG L ADUS X800 X400		0,4	0,65	0,95	E12.B2
▼ Adım (minimum) // Pitch (as of) = 1,0 mm								
1,0	2,7	<b>E12.1100.27 E R/L</b>	R AG81 L ANYY X800 X400		0,6	0,8	1,2	E12.B2
▼ Adım (minimum) // Pitch (as of) = 1,25 mm								
1,25	2,7	<b>E12.1125.27 E R/L</b>	R AAJH L AG1Y X800 X400		0,6	1,0	1,5	E12.B2
▼ Adım (minimum) // Pitch (as of) = 1,5 mm								
1,5	3,7	<b>E12.1150.37 E R/L</b>	R AGCV L AK0V X800 X400		0,8	1,15	1,85	E12.C3
▼ Adım (minimum) // Pitch (as of) = 1,75 mm								
1,75	3,7	<b>E12.1175.37 E R/L</b>	R AP4F L AEWN X800 X400		1,0	1,3	2,2	E12.C3
▼ Adım (minimum) // Pitch (as of) = 2,0 mm								
2,0	5,3	<b>E12.1200.53 E R/L</b>	R AJXB L AFHY X800 X400		1,0	1,5	2,5	E12.D4
▼ Adım (minimum) // Pitch (as of) = 2,5 mm								
2,5	5,3	<b>E12.1250.53 E R/L</b>	R AMPE L AMXX X800 X400		1,2	1,8	3,2	E12.D4
▼ Adım (minimum) // Pitch (as of) = 3,0 mm								
3,0	6,3	<b>E12.1300.63 E R/L</b>	R AH9W L AFPX X800 X400		1,6	2,2	3,8	E12.D4

Benzer takımları bir sonraki sayfada bulabilirsiniz!  
Related Items can be found on the following page as well!Tablonun Devamı  
Continued TableSipariş örneği // Order example: **E12.1080.27 E R X800** (R = Sağ model // Right hand version, X800 = Kesici kalitesi // Grade)



## Dış sonu boşaltma

DIN 76 profil A'ye uygun, dış sonu boşaltma uygulamaları için tasarlanmış kesici takımlar.

## Thread Reliefs

Thread reliefs, comp. to DIN 76 profil A.

Kesme parametreleri // Cutting parameters (start)

f	Vc
0,04 mm/U	Sayfa/Page 40

Uyumlu takım tutucu sayfaları // Suitable toolholders on page  
7, 8, 9, 10, 11, 12, 14, 15



SP  
HM R Referans  
Legend 37

QR-Code [www.simtek.info/cp/511](http://www.simtek.info/cp/511)  
Tara // Scan veya ziyaret edin // or visit

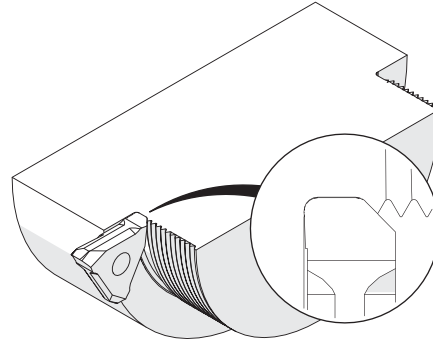
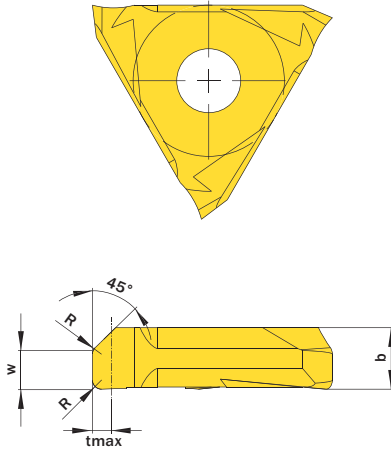

Görseldeki çizim/Drawing shows: E12.3150.53 E R

Adım (minimum) Pitch (as of)	b	Ürün kodu Part number	Webcode <a href="http://www.simtek.com/webcode">www.simtek.com/webcode</a>	Bizim tavsiyemiz Our first choice	R	tmax	w ±0,05	Connectcode <a href="http://www.simtek.com/code">www.simtek.com/code</a>
mm	mm			P K M N S	mm	mm	mm	

Tablonun Devamı  
Continued Table

Benzer takımları bir önceki sayfada bulabilirsiniz!  
Related items can be found on the following page as well!

▼ Adım (minimum) // Pitch (as of) = 0,5 mm	0,5	1,7	<b>E12.3050.17 E R/L</b>	R AFMU L	AJY5 X800 X400	0,2	0,4	1,1	E12.A1 E12.A2
▼ Adım (minimum) // Pitch (as of) = 0,6 mm	0,6	2,7	<b>E12.3060.27 E R/L</b>	R AMQH L	AN7X X800 X400	0,4	0,5	1,3	E12.B2
▼ Adım (minimum) // Pitch (as of) = 0,8 mm	0,8	2,7	<b>E12.3080.27 E R/L</b>	R AAJ4 L	AHTJ X800 X400	0,4	0,65	1,75	E12.B2
▼ Adım (minimum) // Pitch (as of) = 1,0 mm	1,0	3,7	<b>E12.3100.37 E R/L</b>	R AHYA L	AFHT X800 X400	0,6	0,8	2,2	E12.C3
▼ Adım (minimum) // Pitch (as of) = 1,25 mm	1,25	5,3	<b>E12.3125.53 E R/L</b>	R AB82 L	ANGJ X800 X400	0,6	1,0	2,8	E12.D4
▼ Adım (minimum) // Pitch (as of) = 1,5 mm	1,5	5,3	<b>E12.3150.53 E R/L</b>	R AK1C L	AMXF X800 X400	0,8	1,15	3,35	E12.D4

İ Sipariş örneği // Order example: **E12.3125.53 E R X800** (R = Sağ model // Right hand version, X800 = Kesici kalitesi // Grade)

## Kesme

Hassas taşlanmış kesici takımlar, farklı aç ve genişliklerde standart olarak mevcuttur. Talaş bükücü formlu seçenekleri mevcuttur.

## Parting Off

Available in different angles, widths and with/without ground chip form channel.

Kesme parametreleri // Cutting parameters (start)

f	Vc
0,08 mm/U	Sayfa/Page 40

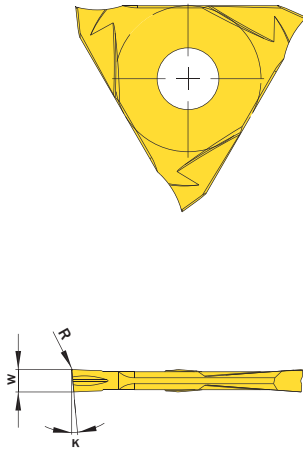
Uyumlu takım tutucu sayfaları // Suitable toolholders on page  
7, 8, 9, 10, 11, 12, 13, 14, 15SP  
HM  
RReferans  
Legend 37QR-Code [www.simtek.info/cp/513](http://www.simtek.info/cp/513)  
Tara // Scan veya ziyaret edin // or visit

Benzetme resimler/Similar illustrations

E12...00 P R  
E12...PS RE12...11 P R  
E12...PT R

! Kullanılabilir metaryeller için sayfanın altında yer alan bilgiyi inceleyin  
! Machineable materials. See below.

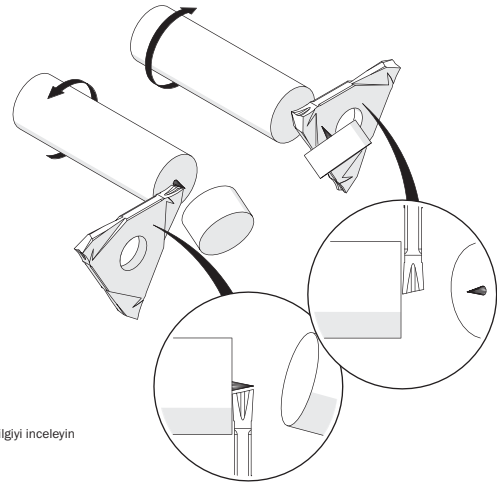

Görseldeki çizim/Drawing shows: E12.1520.11 P R

K	w <sup>-0,05</sup> mm	Ürün kodu Part number	Webcode <a href="http://www.simtek.com/webcode">www.simtek.com/webcode</a>	Bizim tavsiyemiz Our first choice	Talaş bükücü form With chip form channel	R mm	Connectcode <a href="http://www.simtek.com/code">www.simtek.com/code</a>
▼ w = 1,0 mm							
12°	1,0	<b>E12.1210.00 P R/L</b>	R AFQD L AB4M	X800 X400	Hayır/No	0,1	E12.A1 E12.A2
12°	1,0	<b>E12.1210.11 P R/L</b>	R ANDX L AMEB	X800 X400	Evet/Yes	0,1	E12.A1 E12.A2
▼ w = 1,3 mm							
6°-7°	1,3	<b>E12.0613.00 P R/L</b>	R AD3K L AHKK	X800 X400	Hayır/No	0,1	E12.A1 E12.A2
6°-7°	1,3	<b>E12.0613.11 P R/L</b>	R ABPV L AEZZ	X800 X400	Evet/Yes	0,1	E12.A1 E12.A2
▼ w = 1,6 mm							
6°-7°	1,6	<b>E12.0516.00 P R/L</b>	R ACV8 L AF73	X800 X400	Hayır/No	0,1	E12.A1 E12.A2
6°-7°	1,6	<b>E12.0516.11 P R/L</b>	R AMGM L ACKA	X800 X400	Evet/Yes	0,1	E12.A1 E12.A2
6°-7°	1,6	<b>E12.0516.68 PS R/L</b>	R AWEK L AWEN	X800 X400	Hayır/No	0,1	E68.A1
6°-7°	1,6	<b>E12.0516.68 PT R/L</b>	R AWEQ L AWEQ	X800 X400	Evet/Yes	0,1	E68.A1
▼ w = 2,0 mm							
5°-6°	2,0	<b>E12.0520.00 P R/L</b>	R AC2J L ACEX	X800 X400	Hayır/No	0,1	E12.A1 E12.A2
5°-6°	2,0	<b>E12.0520.11 P R/L</b>	R ANDM L AJEN	X800 X400	Evet/Yes	0,1	E12.A1 E12.A2
15°	2,0	<b>E12.1520.11 P R/L</b>	R AFED L APJT	X800 X400	Evet/Yes	0,1	E12.A1 E12.A2
▼ w = 2,1 mm							
5°-6°	2,1	<b>E12.0521.11 P R/L</b>	R AN1B L AHHT	X800 X400	Evet/Yes	0,1	E12.A2 E12.B2

! Sipariş örneği // Order example: **E12.0516.68 PS R X800** (R = Sağ model // Right hand version, X800 = Kesici kalitesi // Grade)

! Çok çeşitli iş parçası malzemeleri ve özellikle uzun talaş oluşturan malzemeler ve yüksek kesme derinlikleri için.

! For a wide variety of work piece materials as well as especially for long-chipping materials and high cutting depths.

## Alın kanal açma

Farklı genişliklerde alın kanal açma uygulamaları için tasarlanmış kesici takımlar.

## Face Grooving

For face grooves in different widths.

Kesme parametreleri // Cutting parameters (start)

f	Vc
0,04 mm/U	Sayfa/Page 40

Uyumlu takım tutucu sayfaları // Suitable toolholders on page  
7, 8, 9, 10, 11, 12, 14



Referans Legend 37

QR-Code www.simtek.info/cp/509  
Tara // Scan veya ziyaret edin // or visit

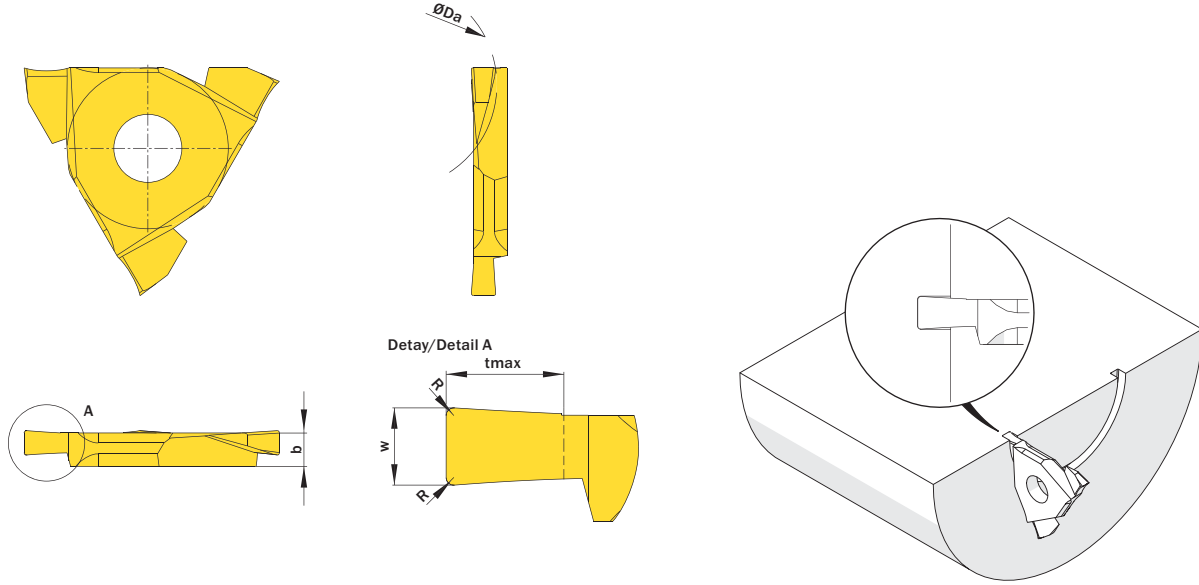

Görseldeki çizim/Drawing shows: E12.3020.02 A R

w ±0,02	Ürün kodu Part number	Webcode www.simtek.com/webcode	Bizim tavsiyemiz Our first choice	b	ØDa	R	tmax	Connectcode www.simtek.com/code
mm			P K M N S	mm	mm	mm	mm	
1,5	<b>E12.2015.02 A R/L</b>	R AM85 L AMEV	X800 X400	2,7	30,0	0,2	2,0	<b>E12.B2</b>
2,0	<b>E12.3020.02 A R/L</b>	R ADEQ L APQJ	X800 X400	2,7	30,0	0,2	3,0	<b>E12.B2</b>
3,0	<b>E12.3030.02 A R/L</b>	R ADK0 L AK9X	X800 X400	3,7	30,0	0,2	3,0	<b>E12.C3</b>

|| Sipariş örneği // Order example: **E12.3020.02 A R X800** (R = Sağ model // Right hand version, X800 = Kesici kalitesi // Grade)

## Poli-V Kasnak Kanalları

J ve K profilleri için tasarlanmış Poly-V-Kasnak uygulamaları için kesici takımlar.

## Poly-V Belt Grooves

For Poly-V-profiles J and K.

Kesme parametreleri // Cutting parameters (start)

f	Vc
0,04 mm/U	Sayfa/Page 40

Uyumlu takım tutucu sayfaları // Suitable toolholders on page  
7, 8, 9, 10, 11, 12, 14



SP Referans  
HM Legend 37

QR-Code www.simtek.info/cp/512  
Tara // Scan veya ziyaret edin // or visit

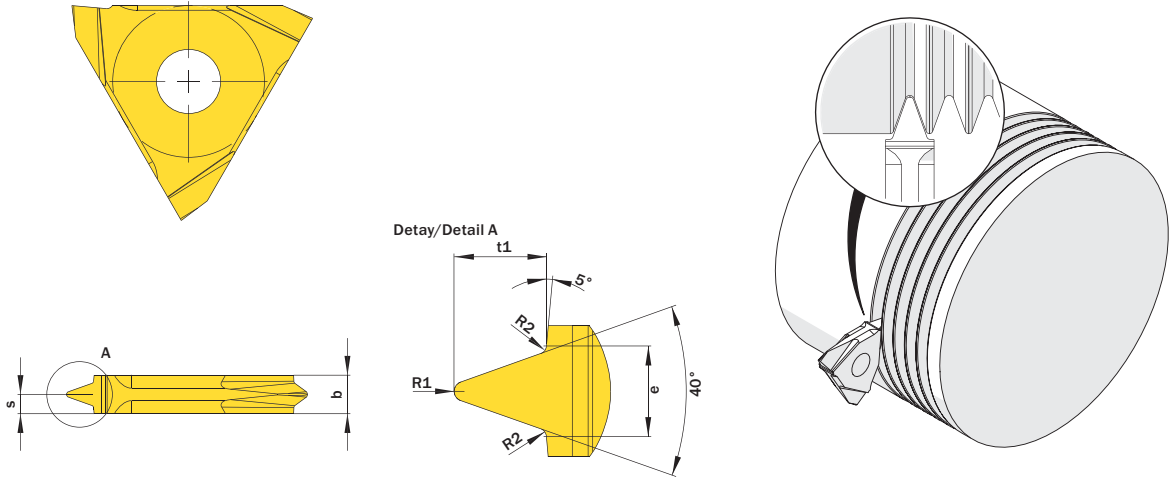

Görseldeki çizim/Drawing shows: E12.0223.30 J

e	R1	R2	b ±0,02	Ürün kodu Part number	Webcode www.simtek.com/webcode	Bizim tavsiyemiz Our first choice	Profil Profile	s	t1	Connectcode www.simtek.com/code
mm	mm	mm	mm			P K M N S		mm	mm	
2,34	0,25	0,2	3,3	E12.0223.30 J	ADQ4	X800 X400	J	1,65	2,3	E12.C3
3,56	0,35	0,25	4,3	E12.0356.43 J	AFAV	X800 X400	K	2,15	3,69	E12.D4

|| Sipariş örneği // Order example: E12.0356.43 J X800 (X800 = Kesici kalitesi // Grade)

Bilgi // Info

## Referans Legend

SP

CBN

CBN uç // CBN insert

SP

HM

Karbür uç // Carbide insert

TW

ST

Çelik takım tutucu // Steel toolholder

R

Sağ yön versiyonu gösterilmiştir, sol yön versiyonu ters // Right hand version shown, left hand version inversely

LM

Hafif alaşımlar için // For light-alloys

simturn AX

simturn DX

simturn H2

simturn K2

simturn C4

simturn GX

simturn E3

simturn E12

simturn FX

simturn  
Decolletage

simturn OA

Index

37



Gösterge (indeks) // Index

simturn E12 Ürün listesi  
simturn E12 Product list

Ürün kodu // Part Nr.	S/P
TOA.E60.19.03 R	14
TOA.E60.19.04 L	14
TOA.E60.19.04 R	14
TOA.E60.19.23 L	14
TOA.E60.19.23 R	14
TOA.E60.V1.01 L	8
TOA.E60.V1.01 R	8
TOA.E60.V1.02 L	8
TOA.E60.V1.02 R	8
TOA.E60.V1.03 L	8
TOA.E60.V1.03 R	8
TOA.E60.V1.23 L	8
TOA.E60.V1.23 R	8
TOG.K.E12.C1.01R	15

simturn AX

simturn DX

simturn H2

simturn K2

simturn C4

simturn GX

simturn E3

simturn E12

simturn FX

simturn  
Decolletage

simturn OA

Index

39

## Bilgi // Info

Kesme hızı parametreleri hakkında genel bilgi  
Information About The Cutting ParametersKesme hızı önerisi sayfası  
Cutting speed recommendation as of page

41

Kesme hızı parametreleri ve önerileri hakkında genel bilgi  
General information about the cutting parameters recommendations

Kesme hızı ve ilerleme hızları için verilen kesme parametreleri başlangıç değerleri içindir ve standart uygulama koşulları için tavsiye edilir.

En iyi kesme hızı parametreleri, çok çeşitli işleme, iş parçası takım ve genel makina durumuna bağlı olup, verilen başlangıç değerlerinin altında ve üstünde olabilir.

The given cutting parameters for speed and feed rates are meant as initial start values and are estimated for standard application conditions.

The best parameters depend on a wide variety of machine, workpiece and tool related conditions, for example the general machine condition, and can be above or below the given start values.

Örnek etki faktörleri ve bunların kesme hızı parametreleri üzerindeki etkisi  
Example factors of influence and their effect on the cutting parameters

Değerleri azaltın // Reduce values

Değerleri arttırın // Increase values

Zor işleme ve sıkma koşulları Difficult machine and clamping conditions	Katı işleme ve sıkma koşulları Solid machine and clamping conditions
İşlenmesi zor malzemeler Difficult to machine materials	İşlenmesi kolay malzemeler Easy to machine materials
Uzun takım erişimi(L2) Long tool reach (L2)	Kısa takım erişimi(L2) Small tool reach (L2)
Talaş formu geometrisi yok No chip form geometry	Talaş formu geometrilili With chip form geometry

Kesici kalitesinin malzeme sertliğine göre uygunluğu  
Suitability of cutting grades in relation to work piece hardness

Kesici kalitesi // Grade	Yaklaşık olarak önerilen // Recommended up to approx.
X8*	HRC52
*T90 / *T91	HRC62
CBN	HRC65 (Uygulamaya bağlı // Depending on application)



# Kesme hızı önerisi

## Cutting Speed Recommendation

ISO-Grup ISO-Group	Önerilen kesici kalitesi (*) Recommended Cutting Grade	Malzeme bilgisi Work piece material	Alt grup Sub-group	Alternatif kesici kalitesi Alternative cutting grade	Vc m/min (Start)
P	X800 X802 X804 X808	Çelik, alaşımsız Steel, unalloyed	≤ 0,15 % C	X400 / X600	210
			0,15 - 0,4 % C	X400 / X600	190
			≥ 0,4 % C	X400 / X600	180
		Çelik, düşük alaşımlı (alaşım elementleri ≤ % 5) Steel, low alloyed (alloying elements ≤ 5%)	Sertleştirilmemiş Non-hardened	X400 / X600	170
			Sertleştirilmiş Hardened	X400 / X600	100
		Çelik, yüksek alaşımlı (alaşım elementleri > % 5) Steel, high alloyed (Alloying elements > 5%)	Tavlınmış Annealed	X400 / X600	110
			Sertleştirilmiş Hardened	X400 / X600	90
		Döküm Castings	Alaşımsız Unalloyed	X400 / X600	150
			Düşük alaşımlı (alaşım elementleri ≤ % 5) Low alloyed (Alloying elements ≤ 5%)	X400 / X600	120
			Yüksek alaşımlı (alaşım elementleri > % 5) High alloyed (Alloying elements > 5%)	X400 / X600	90
M	Paslanmaz çelik Ferritik / Martensitik Stainless Steel Ferritic/Martensitic	Sertleştirilmemiş Non-hardened	*T41	150	
		PH sertleştirilmiş PH-hardened	*T41	110	
		Sertleştirilmiş Hardened	*T41	110	
	Paslanmaz çelik Östenitik Stainless Steel Austenitic	Östenitik Austenitic	*T41	140	
		PH sertleştirilmiş PH-hardened	*T41	100	
		Süper östenitik Super Austenitic	*T41	110	
	Paslanmaz çelik Östenitik-Ferritik (iki katlı) Stainless Steel Austenitic-ferritic (Duplex)	Kaynaklanamaz ≥% 0,05 C Non-weldable ≥ 0,05 % C	*T41	120	
		Kaynaklanabilir <% 0,05 C Weldable < 0,05 % C	*T41	100	
	Paslanmaz Çelik (Döküm) Ferritik / Martensitik Stainless Steel (Cast) Ferritic/martensitic	Sertleştirilmemiş Non-hardened	*T41	130	
		PH sertleştirilmiş PH-hardened	*T41	90	
		Sertleştirilmiş Hardened	*T41	100	
	Paslanmaz Çelik (Döküm) Östenitik Stainless Steel (Cast) Austenitic	Östenitik Austenitic	*T41	130	
		PH sertleştirilmiş PH-hardened	*T41	90	
	Paslanmaz Çelik (Döküm) Östenitik-Ferritik(iki katlı) Stainless Steel (Cast) Austenitic-ferritic (Duplex)	Kaynaklanamaz ≥% 0,05 C Non-weldable ≥ 0,05 % C	*T41	110	
Kaynaklanabilir <% 0,05 C Weldable < 0,05 % C		*T41	90		

## Bilgi // Info

Kesme hızı önerisi  
Cutting Speed Recommendation

ISO-Grup ISO-Group	Önerilen kesici kalitesi (*) Recommended Cutting Grade	Malzeme bilgisi Work piece material	Alt grup Sub-group	Alternatif kesici kalitesi Alternative cutting grade	Vc m/min (Start)
K	X800 X802 X804 X808	Dövülebilir Malleable	Ferritik (kısa talaşlı) Ferritic (short chipping)	*T57	180
			Perlitli (uzun talaşlı) Pearlitic (long chipping)	*T57	150
		Gri dökme demir Grey Cast Iron	Düşük gerilme mukavemeti Low tensile strength	*T57	200
			Yüksek gerilme mukavemeti High tensile strength	*T57	150
	Küresel grafitli dökme demir Spheroidal Graphite cast iron	Ferritik Ferritic	*T57	120	
		Perlitli Pearlitic	*T57	110	
		Martensitik Martensitic	*T57	110	
N	X400 / X600 X402 / X602 X404 / X604 X408 / X608	Alüminyum alaşımları, Dövme Aluminium alloys, Whrought	Sertleştirilemez Can not be hardened	*F25	590
			Sertleştirilebilir, sertleştirilmiş Can be hardened, hardened	*F25	530
		Alüminyum alaşımları, Döküm Aluminium alloys, Cast	Sertleştirilemez Can not be hardened	*F25	590
			Sertleştirilebilir, sertleştirilmiş Can be hardened, hardened	*F25	530
	Alüminyum alaşımları, Döküm Aluminium alloys, Cast	< 5 % Si	*F25	240	
		5 - 12 % Si	*X17	240	
		> 12 % Si	PKD <sup>1</sup>	180	
	Bakır ve Bakır alaşımları Copper and Copper Alloys	Serbest Kesme Alaşımları, ≥1% Pb Free Cutting Alloys, ≥1 % Pb	*F25	290	
		Pirinç, kurşunlu bronzlar, ≤1 % Pb Brass, leaded bronzes, ≤ 1 % Pb	*F25	290	
		Bronz, elektrolitik bakır dahil kurşunsuz bakır Bronze, lead-free copper incl. electrolytic copper	*F25	210	

# Kesme hızı önerisi

## Cutting Speed Recommendation

ISO-Grup ISO-Group	Önerilen kesici kalitesi (*) Recommended Cutting Grade	Malzeme bilgisi Work piece material	Alt grup Sub-group	Alternatif kesici kalitesi Alternative cutting grade	Vc m/min (Start)
S	X400 / X600 X402 / X602 X404 / X604 X408 / X608	Isıya dayanıklı süper alaşımlar, Fe-bazlı Heat-resistant super alloys, Fe-based	Tavlı veya çözelti işlemine tabi tutulmuş Annealed or solution treated	*X79	40
			Eskitilmiş veya çözelti işlemine tabi tutularak eskitilmiş Aged or solution treated and aged	*X79	30
		Isıya dayanıklı süper alaşımlar Ni-bazlı Heat-resistant super alloys Ni-based	Tavlı veya çözelti işlemine tabi tutulmuş Annealed or solution treated	*X79	40
			Eskitilmiş veya çözelti işlemine tabi tutularak eskitilmiş Aged or solution treated and aged	*X79	20
			Döküm veya döküm ve eskitilmiş Cast or Cast and aged	*X79	30
		Isıya dayanıklı süper alaşımlar Co-bazlı Heat-resistant super alloys Co-based	Tavlı veya çözelti işlemine tabi tutulmuş Annealed or solution treated	*X79	10
	Çözelti işlemine tabi tutulmuş ve eskitilmiş Solution treated and aged		*X79	10	
	Döküm veya döküm ve eskitilmiş Cast or Cast and aged		*X79	10	
	Titanium alaşımları Titanium Alloys	Ticari safılıkta(99,5 % Ti) Commercial pure (99,5 % Ti)	*X79	80	
		$\alpha$ , yakın $\alpha$ ve $\alpha + \beta$ alaşımlar, tavllanmış $\alpha$ , near $\alpha$ and $\alpha + \beta$ alloys, annealed	*X79	40	
		$\alpha + \beta$ eskitilmiş koşullarda alaşımlar ve $\beta$ alaşımları. Tavllanmış veya eskitilmiş $\alpha + \beta$ Alloys in aged conditions as well as $\beta$ alloys. Annealed or aged	*X79	40	
	H	CBN <sup>1</sup>	Sertleştirilmiş çelik Hardened steel	*T91	50
Soğutulmuş dökme demir, döküm veya döküm ve eskitilmiş Chilled cast iron, cast or cast and aged			*T91	90	

1) En iyi sonuçlar için, burada özel bir kesme kenarı geometrisi önerilir.  
Lütfen teknik desteğimizle iletişime geçin: +90 266 376 11 61 veya sales.tr@simtek.com  
For best results, a special cutting edge geometry is recommended here.  
Please contact our technical support +90 266 376 11 61 or sales.tr@simtek.com

2) Öneri, seçilen kesici uçlara bağlıdır. Lütfen kesici ucun katalog sayfasındaki bizim tavsiyemiz alanına bakın.  
Recommendation depends on the chosen cutting inserts. Please look at the cutting grade recommendations on the catalog page of the cutting insert.

## Genel kullanım talimatları General Instructions For Use

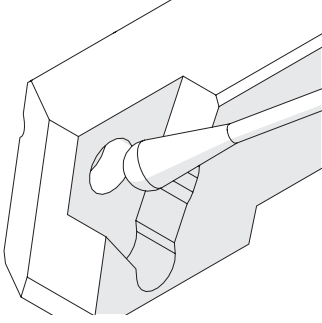

Lütfen takmadan ve kullanmadan önce uç yuvasını iyice temizleyin  
Please clean insert seat well before mounting and use

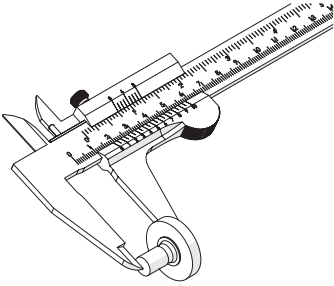

Lütfen iş parçalarınızı sık sık kontrol edin  
Please control your work pieces frequently



Takım ön ayar ve ölçüm cihazlarının kullanılmasını öneririz  
We recommend the use of tool presetting and measuring devices